

## **BASIC WALL**<sup>®</sup>

ABOVE THE GROUND / STEEL WALL  
BAS-05

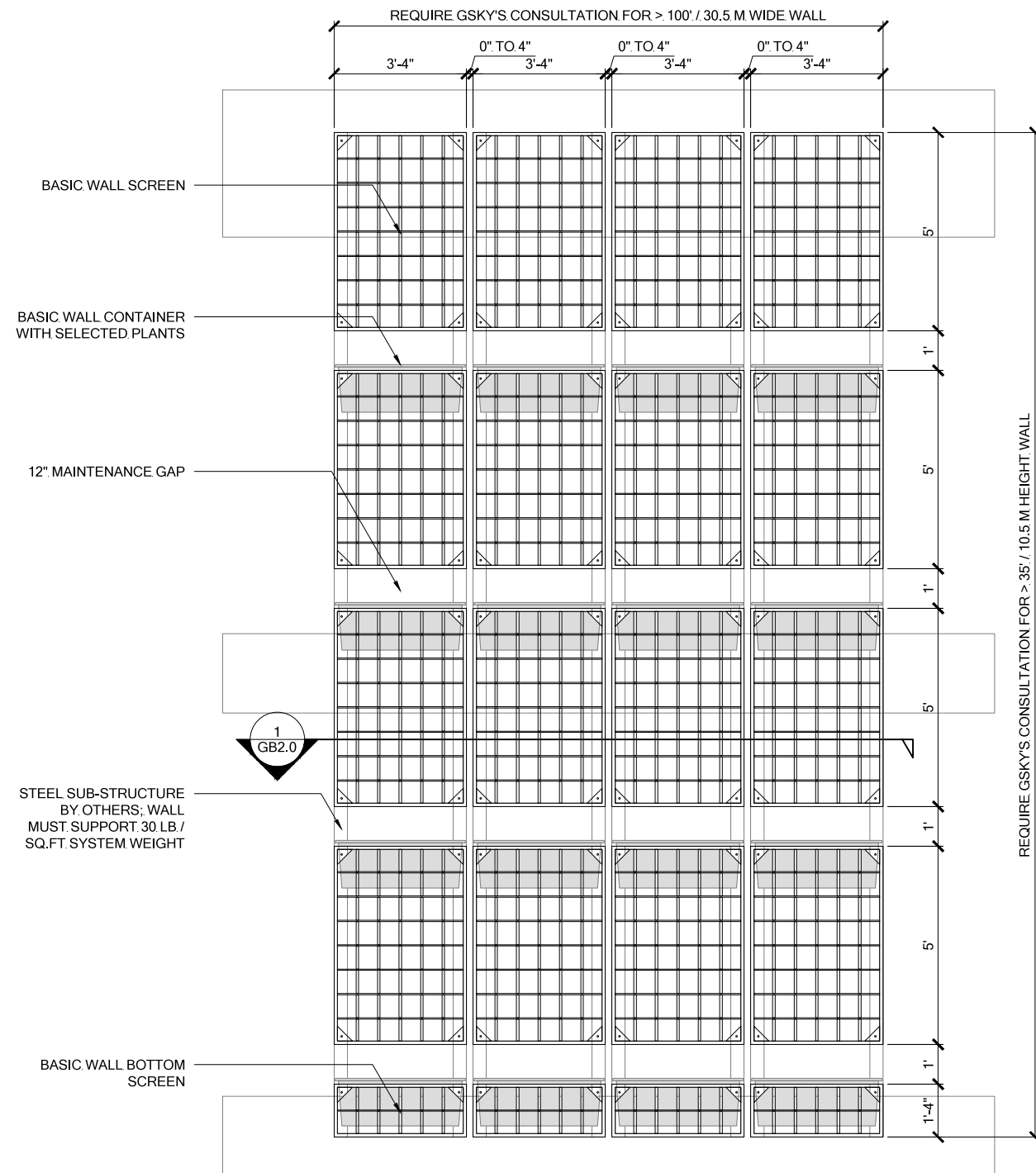

**1 ELEVATION**  
SCALE 1/4" = 1'-0"

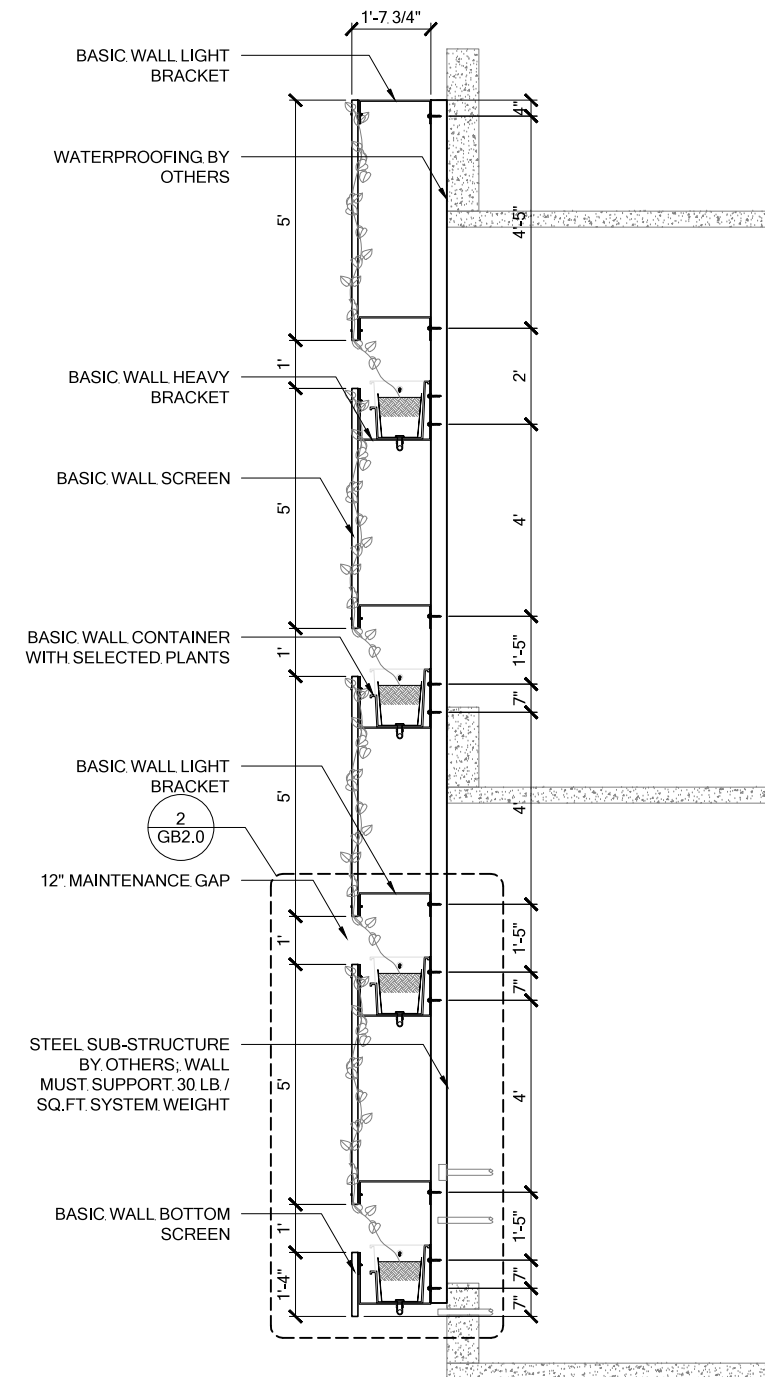

**2 SECTION**  
SCALE 1/4" = 1'-0"



# BASIC WALL®

BAS-05 GENERAL OVERVIEW

MAY 9, 2016 11x17" (A3)

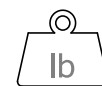

## SYSTEM WEIGHT

Basic wall system weight = 30 lb/sq.ft / 1.3 kg/sq.m.



## REMOTE ICU

SERVICE			
AUTOMATED	At ICU + WALL	At ICU + WALL	At ICU + WALL

## IRRIGATION

Require GSky's consultation for: > 35' / 10.5 m height wall or > 100' / 30.5 m wide wall.

< 8'	OK			
< 13'	OK	OK		
> 13'	OK	OK	OK	OK

## MAINT. ACCESS

Walls over 40' / 12m need additional considerations. See GSky maintenance manual.

# GB1.0

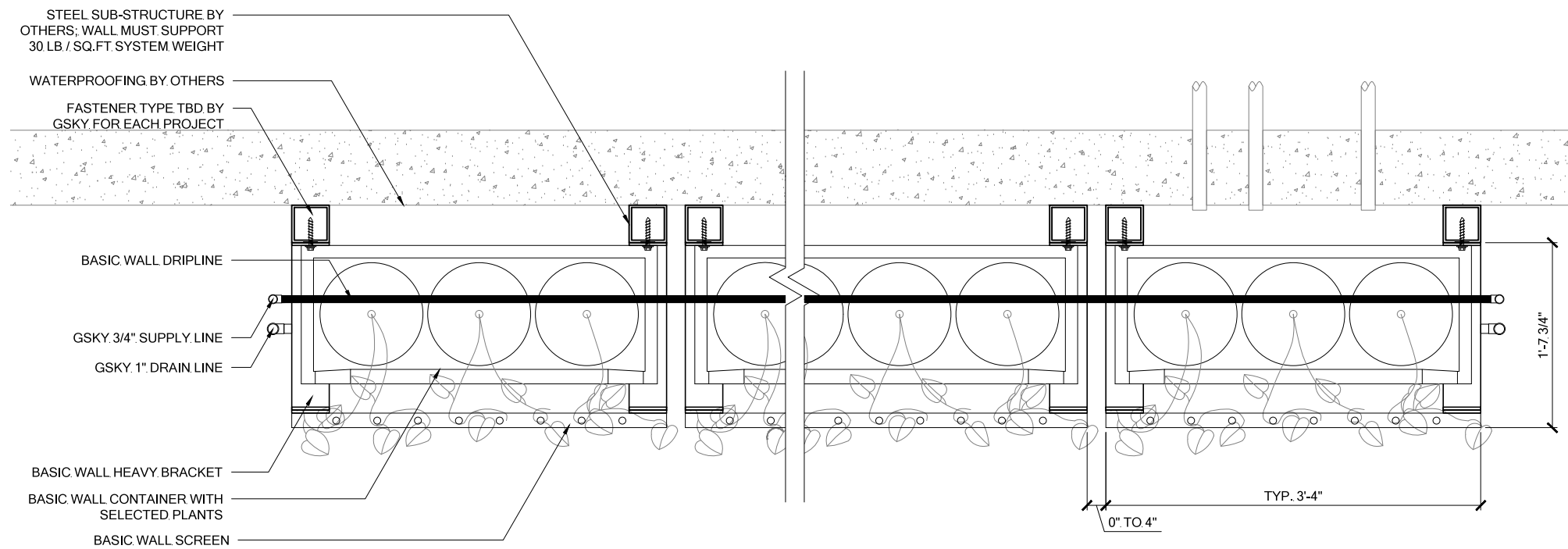

**1 PLAN**  
SCALE 3/4" = 1'-0"

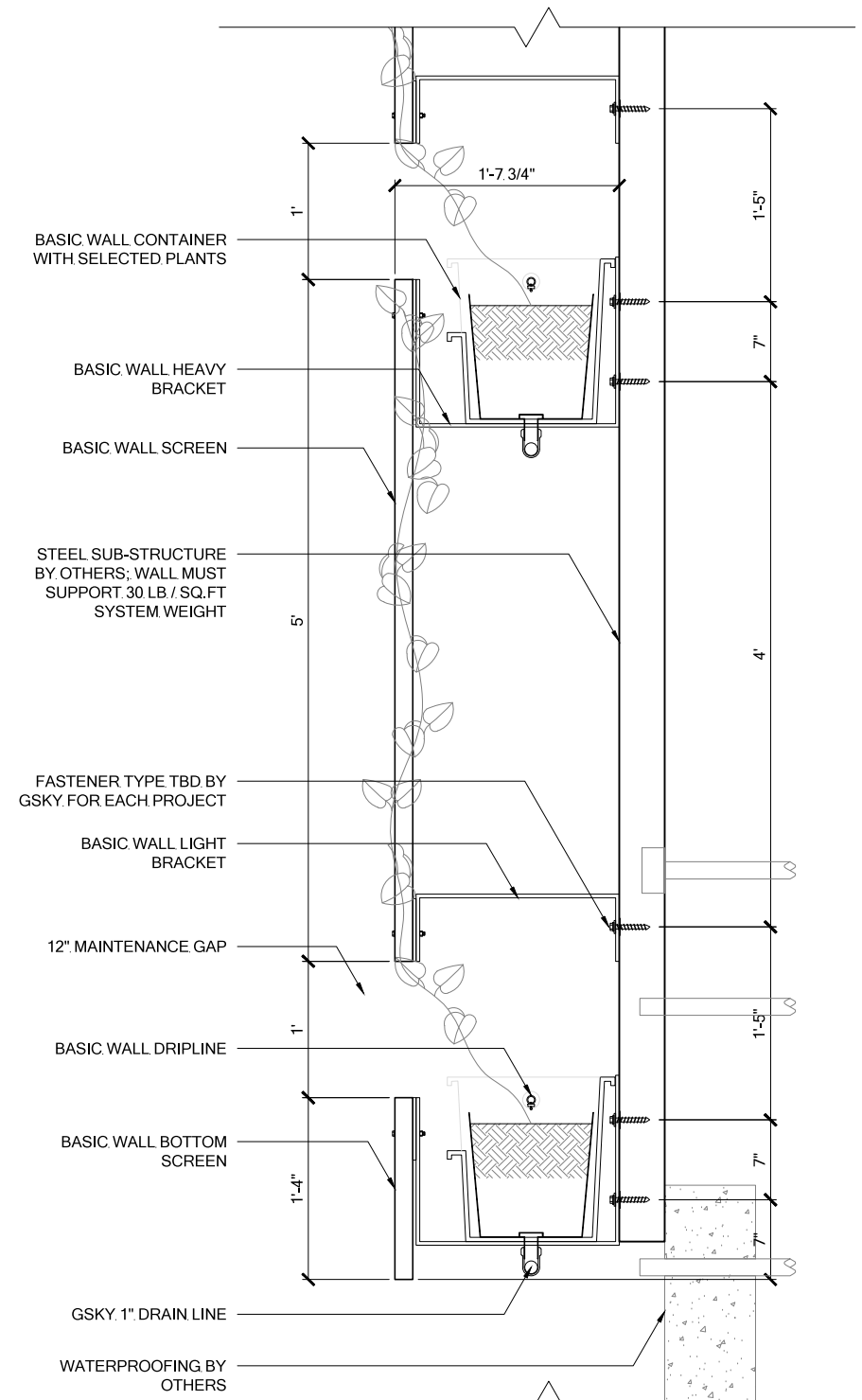

**2 SECTION**  
SCALE 3/4" = 1'-0"



**BASIC WALL®**

BAS-05 DETAILS

MAY 9, 2016 11x17" (A3)



**SYSTEM WEIGHT**

Basic wall system weight = 30 lb/sq.ft / 1.3 kg/sq.m.



**REMOTE ICU**

SERVICE			
AUTOMATED	At ICU + WALL	At ICU + WALL	At ICU + WALL

**IRRIGATION**

Require Gsky's consultation for: > 35' / 10.5 m height wall or > 100' / 30.5 m wide wall.

< 8'	OK			
< 13'	OK	OK		
> 13'	OK	OK	OK	OK

**MAINT. ACCESS**

Walls over 40' / 12m need additional considerations. See Gsky maintenance manual.

**GB2.0**

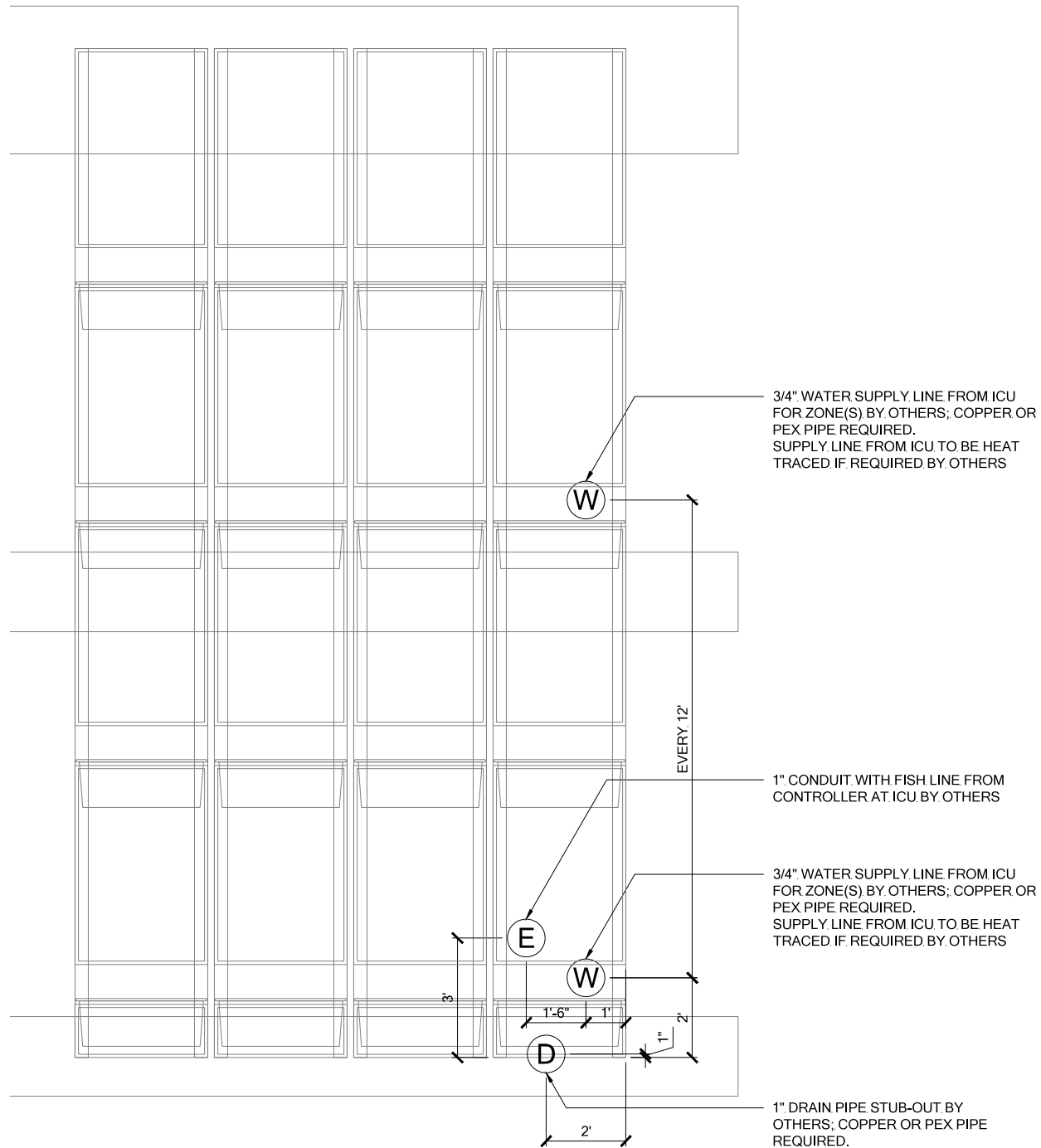

**1 ELEVATION**  
SCALE 1/4" = 1'-0"

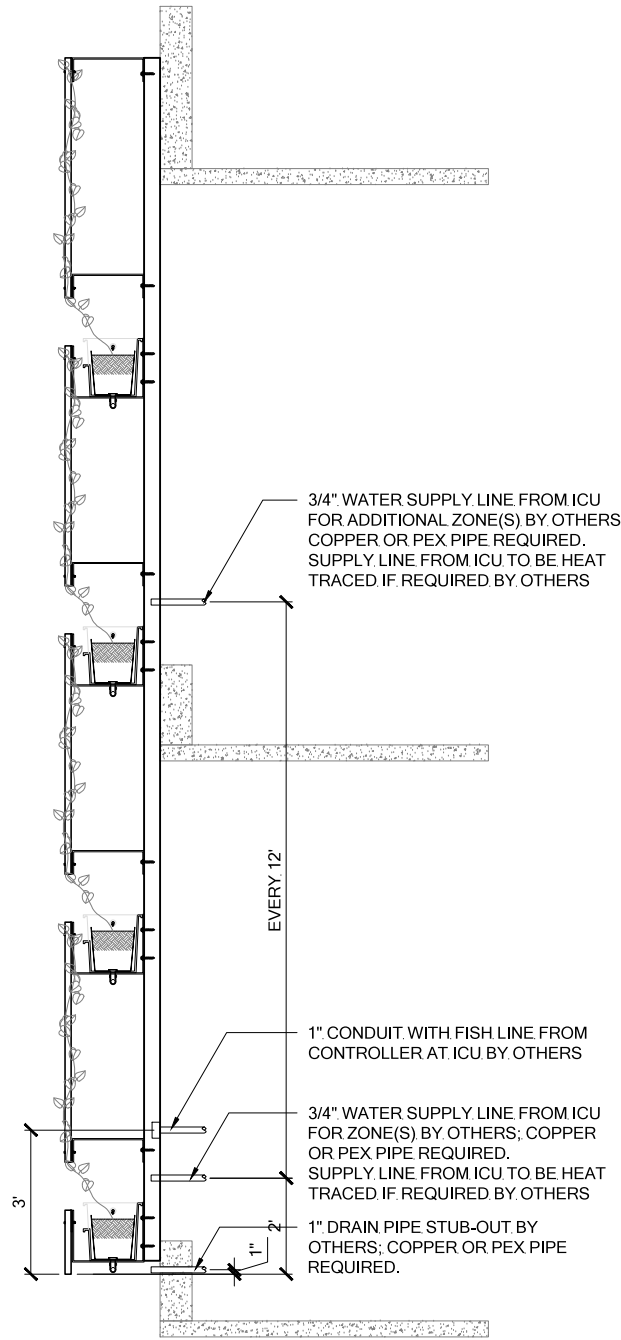

**2 SECTION**  
SCALE 1/4" = 1'-0"

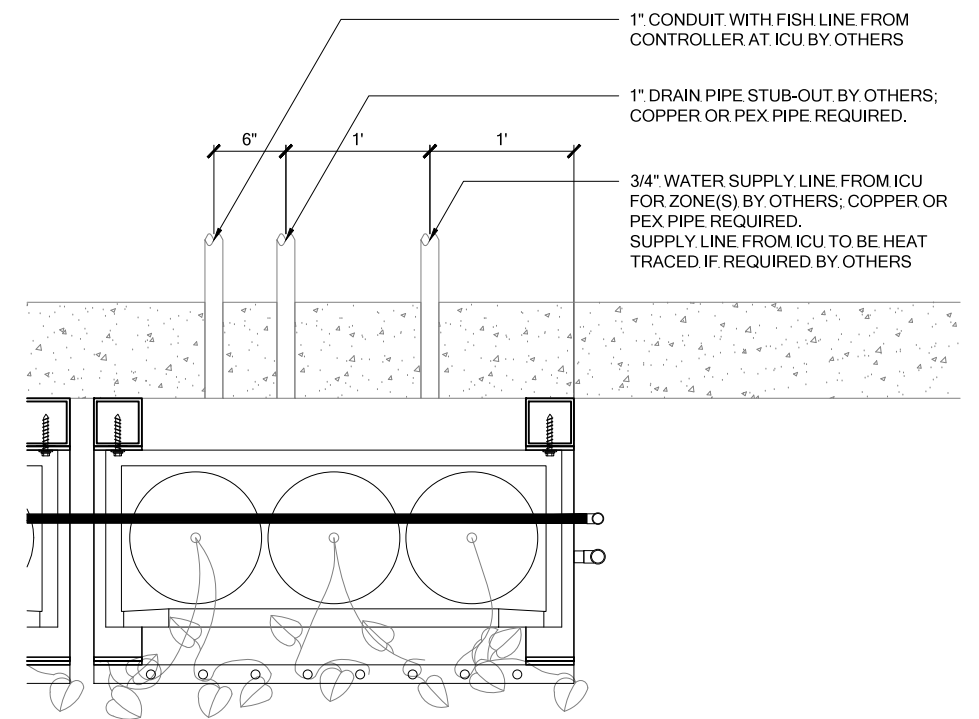

**3 PLAN**  
SCALE 3/4" = 1'-0"



**BASIC WALL®**  
BAS-05 IRRIGATION OVERVIEW  
MAY 9, 2016 11x17" (A3)



**SYSTEM WEIGHT**  
Basic wall system weight  
= 30 lb/sq.ft / 1.3 kg/sq.m.



**REMOTE ICU**

SERVICE			
AUTOMATED	At ICU + WALL	At ICU + WALL	At ICU + WALL

**IRRIGATION**  
Require GSky's consultation  
for: > 35' / 10.5 m height wall  
or > 100' / 30.5 m wide wall.

< 8'	OK			
< 13'	OK	OK		
> 13'	OK	OK	OK	OK

**MAINT. ACCESS**  
Walls over 40' / 12m need additional  
considerations. See GSky  
maintenance manual.

**GB3.0**

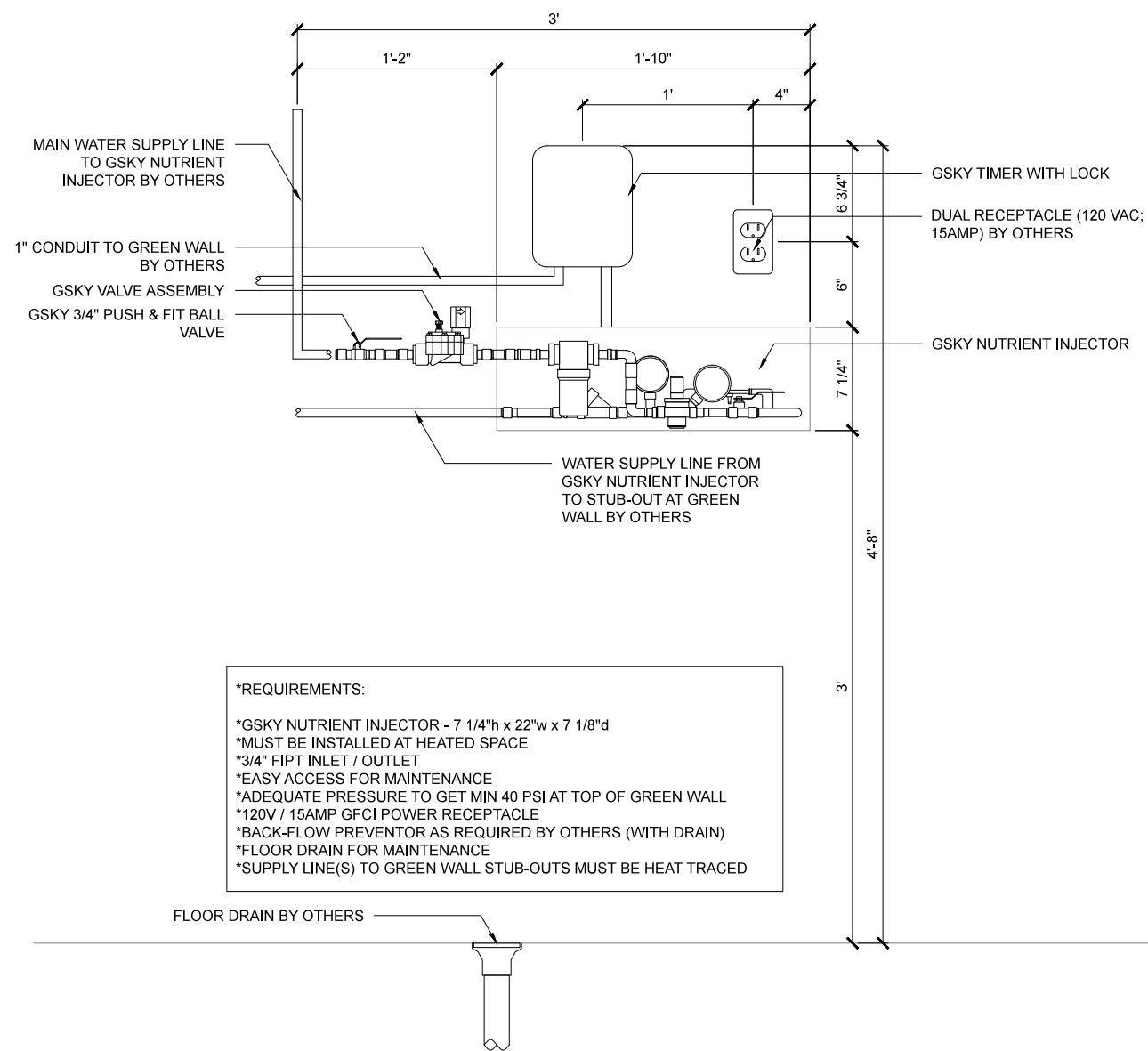

**\*REQUIREMENTS:**  
 \*GSKY NUTRIENT INJECTOR - 7 1/4"h x 22"w x 7 1/8"d  
 \*MUST BE INSTALLED AT HEATED SPACE  
 \*3/4" FIPT INLET / OUTLET  
 \*EASY ACCESS FOR MAINTENANCE  
 \*ADEQUATE PRESSURE TO GET MIN 40 PSI AT TOP OF GREEN WALL  
 \*120V / 15AMP GFCI POWER RECEPTACLE  
 \*BACK-FLOW PREVENTOR AS REQUIRED BY OTHERS (WITH DRAIN)  
 \*FLOOR DRAIN FOR MAINTENANCE  
 \*SUPPLY LINE(S) TO GREEN WALL STUB-OUTS MUST BE HEAT TRACED

**1 SINGLE ZONE - ELEVATION**  
 SCALE 1" = 1'-0"

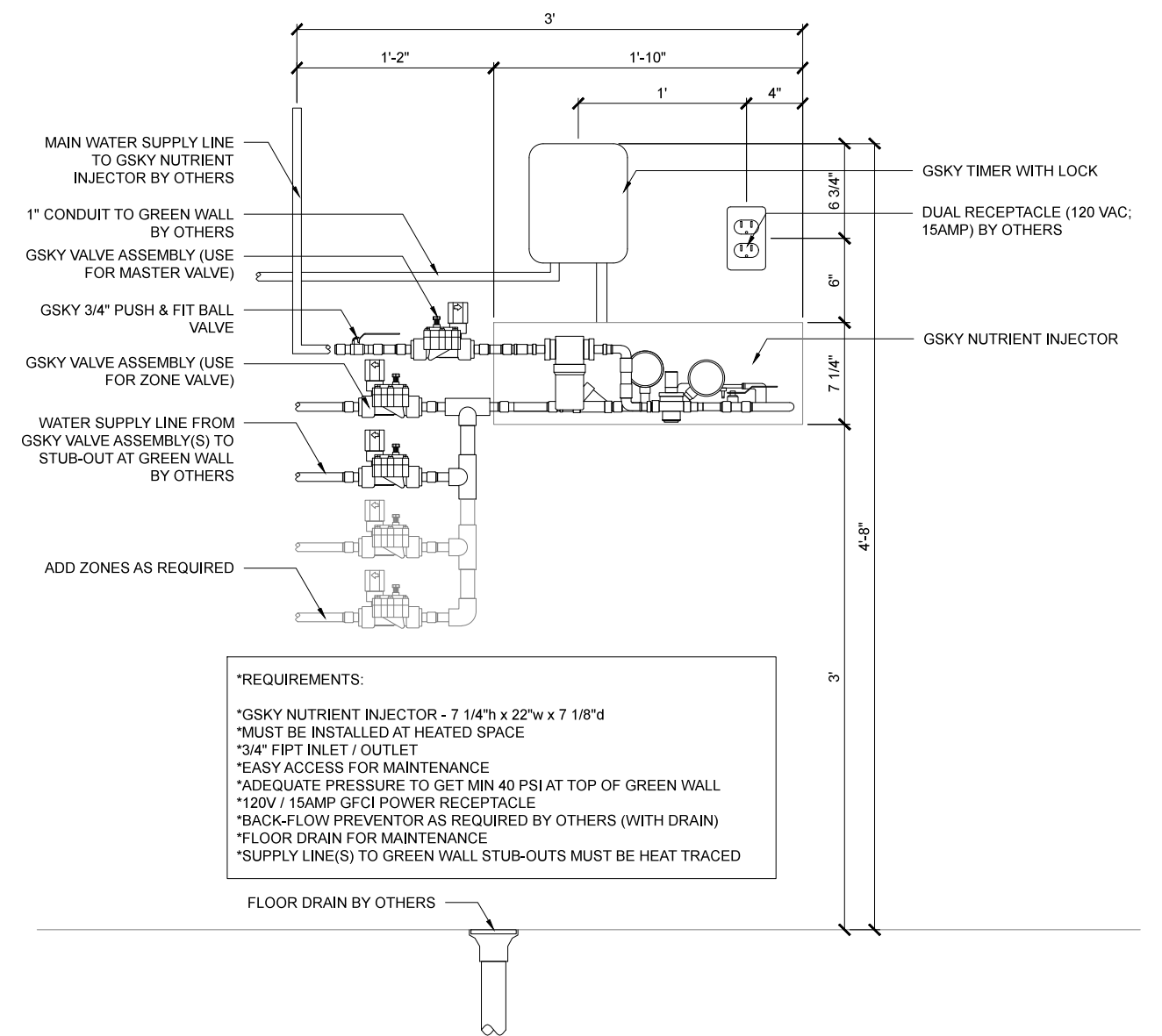

**\*REQUIREMENTS:**  
 \*GSKY NUTRIENT INJECTOR - 7 1/4"h x 22"w x 7 1/8"d  
 \*MUST BE INSTALLED AT HEATED SPACE  
 \*3/4" FIPT INLET / OUTLET  
 \*EASY ACCESS FOR MAINTENANCE  
 \*ADEQUATE PRESSURE TO GET MIN 40 PSI AT TOP OF GREEN WALL  
 \*120V / 15AMP GFCI POWER RECEPTACLE  
 \*BACK-FLOW PREVENTOR AS REQUIRED BY OTHERS (WITH DRAIN)  
 \*FLOOR DRAIN FOR MAINTENANCE  
 \*SUPPLY LINE(S) TO GREEN WALL STUB-OUTS MUST BE HEAT TRACED

**2 MULTI-ZONE - ELEVATION**  
 SCALE 1" = 1'-0"



**BASIC WALL®**  
 BAS-05 IRRIGATION SYSTEM  
 MAY 9, 2016 11x17" (A3)

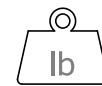

**SYSTEM WEIGHT**  
 Basic wall system weight  
 = 30 lb/sq.ft / 1.3 kg/sq.m.



**REMOTE ICU**

SERVICE			
AUTOMATED	At ICU + WALL	At ICU + WALL	At ICU + WALL

**IRRIGATION**  
 Require Gsky's consultation for:  
 > 35' / 10.5 m height wall  
 or > 100' / 30.5 m wide wall.

< 8'	OK			
< 13'	OK	OK		
> 13'	OK	OK	OK	OK

**MAINT. ACCESS**  
 Walls over 40' / 12m need additional considerations. See Gsky maintenance manual.

**GB3.1**