

VERSA WALL[®]

SPECIAL DETAILS

VER. 1.1

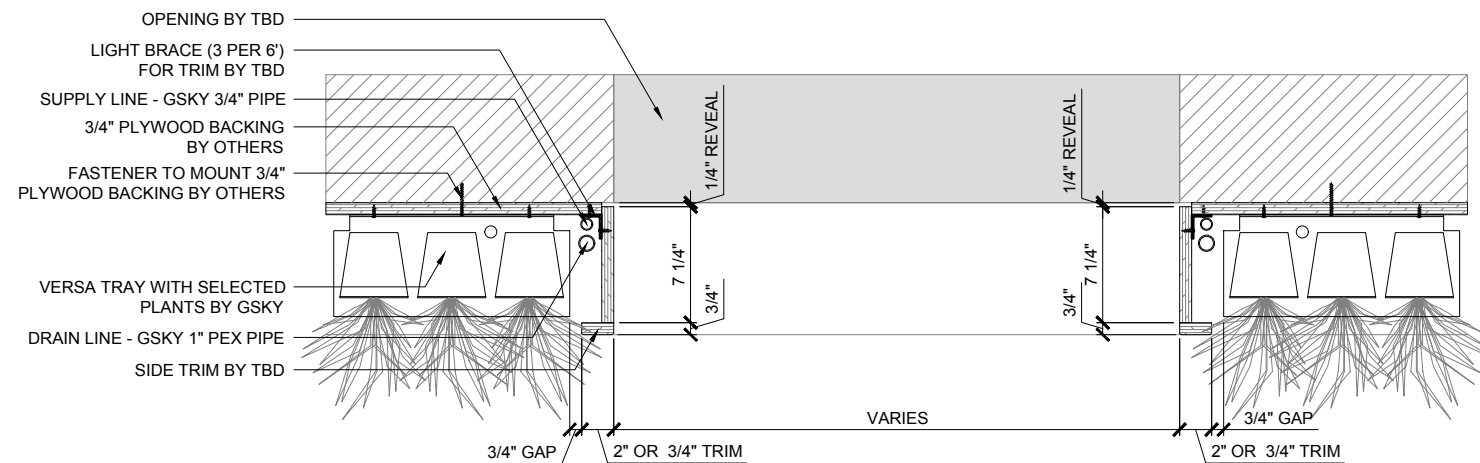
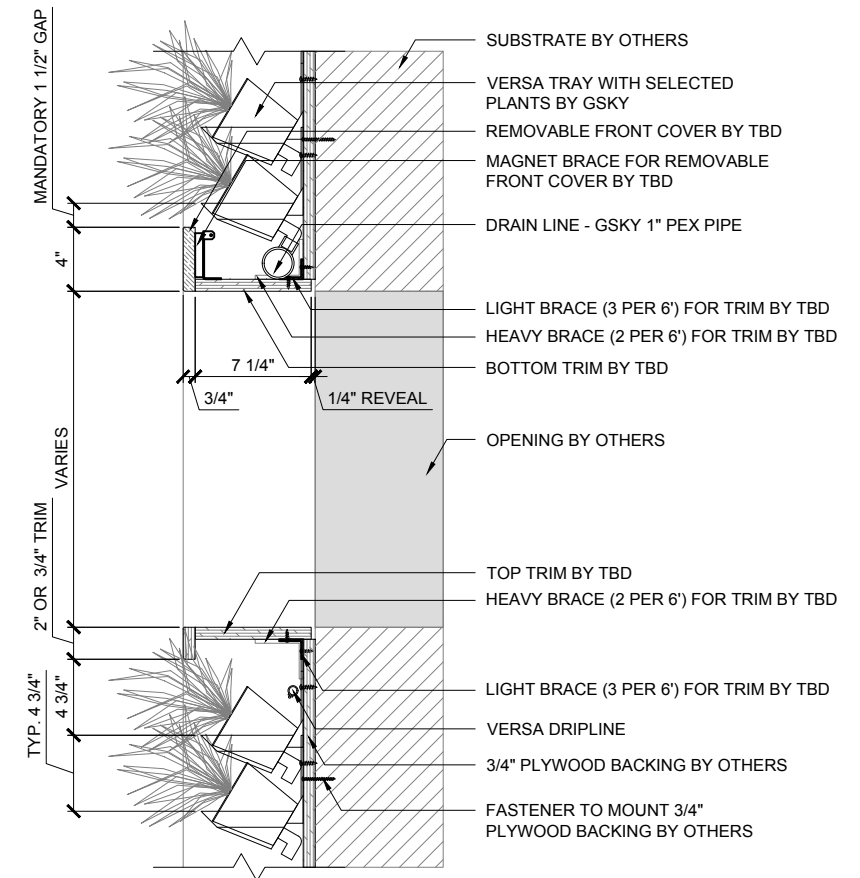
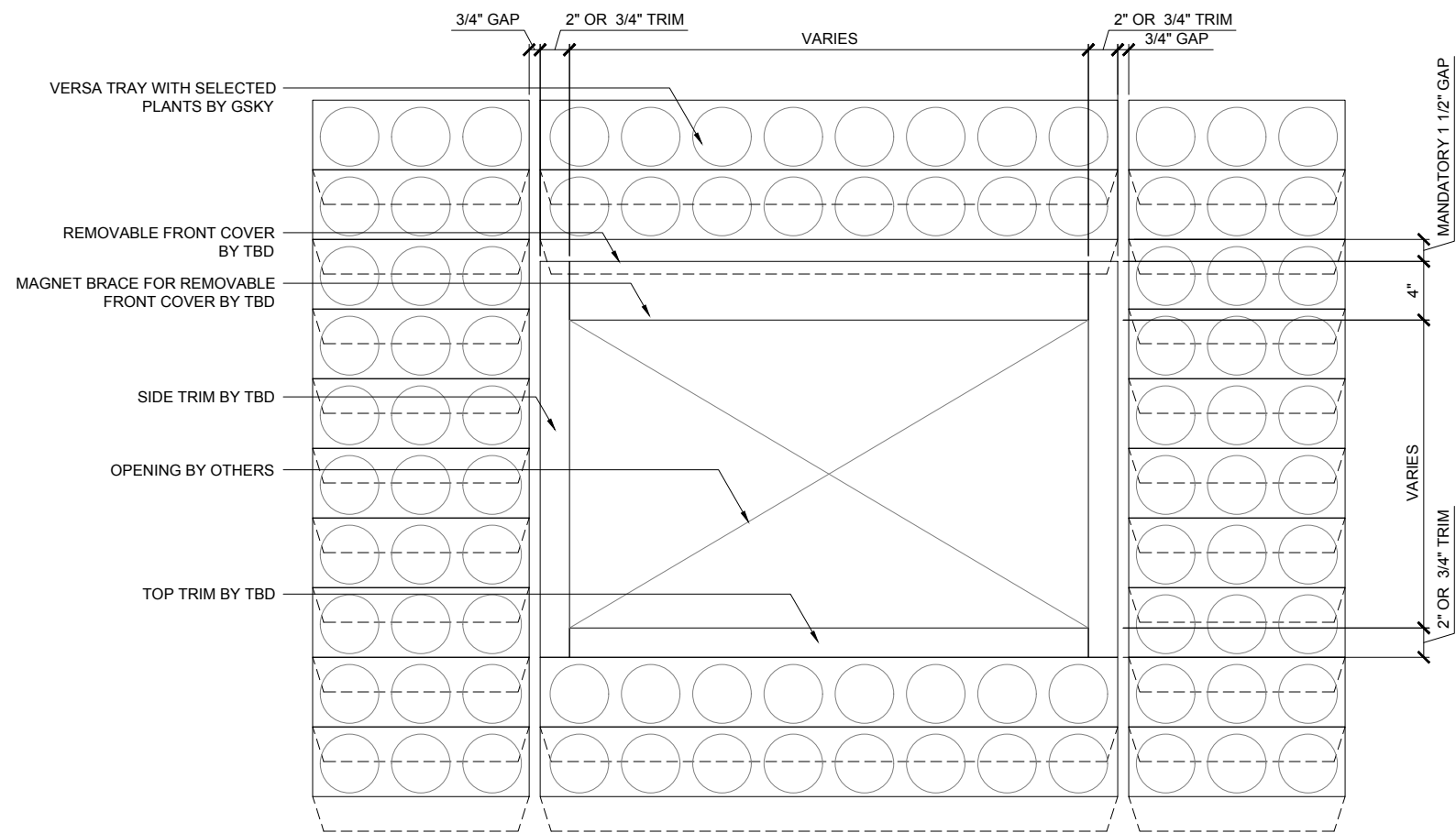

VERSA WALL[®]

DETAIL - WALL OPENING

VER. 1.1

11x17" (A3)



Duration
10-12 hrs/day
Color Temp
4000-4500K
Intensity
150fc / 1500 lux
(Even Flood)

LIGHTING
LED or Metal Halide Lights
recommended



< 8'	OK		
< 13'	OK	OK	
> 13'		OK	OK

MAINT. ACCESS
Walls over 40' / 12m need additional
considerations. See GSKy
maintenance manual.

GVD1.0

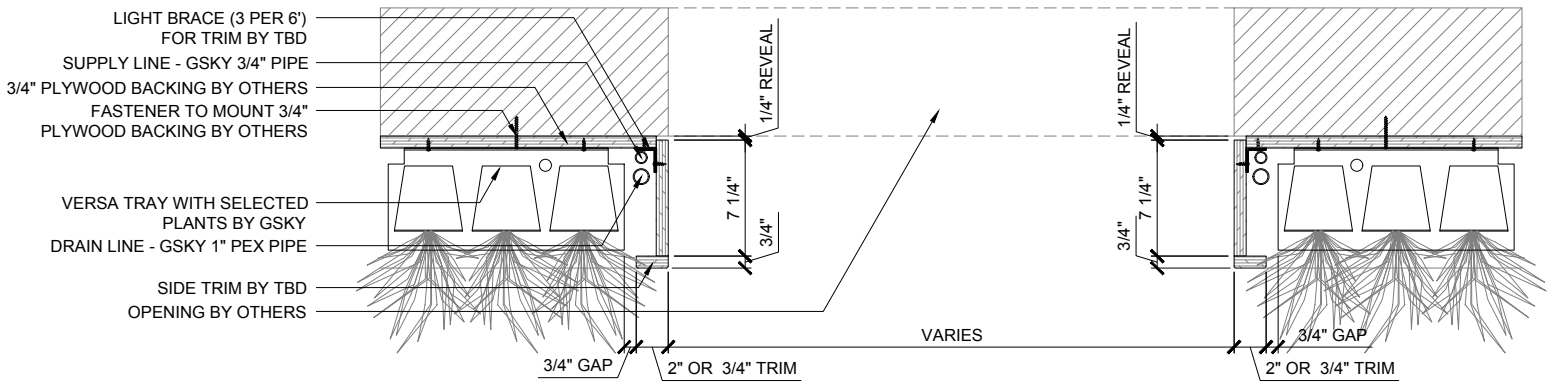
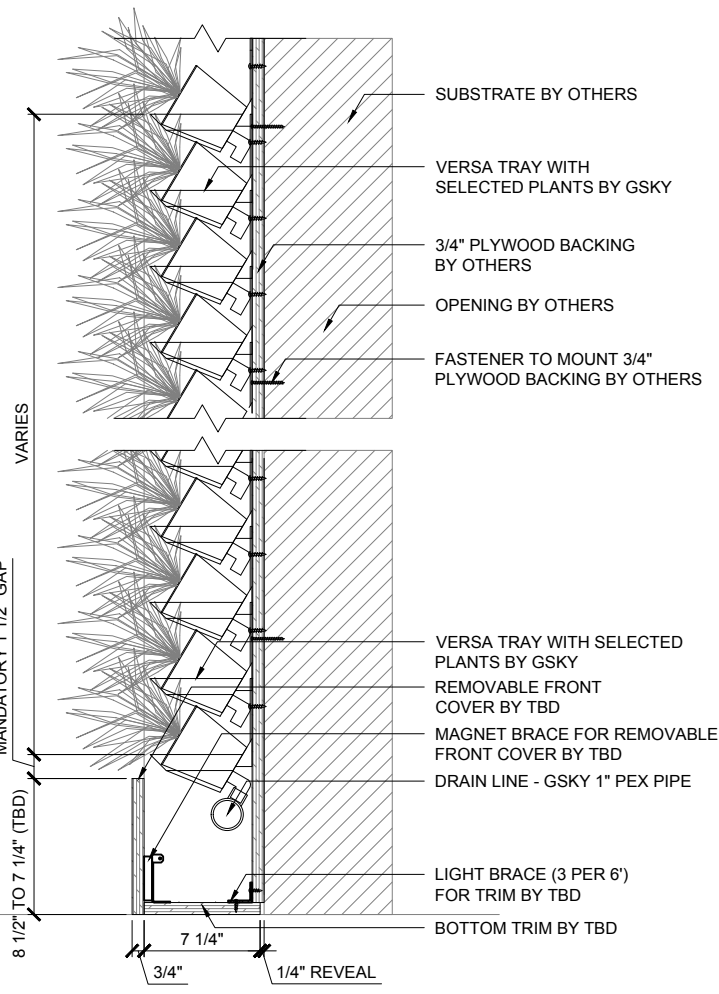
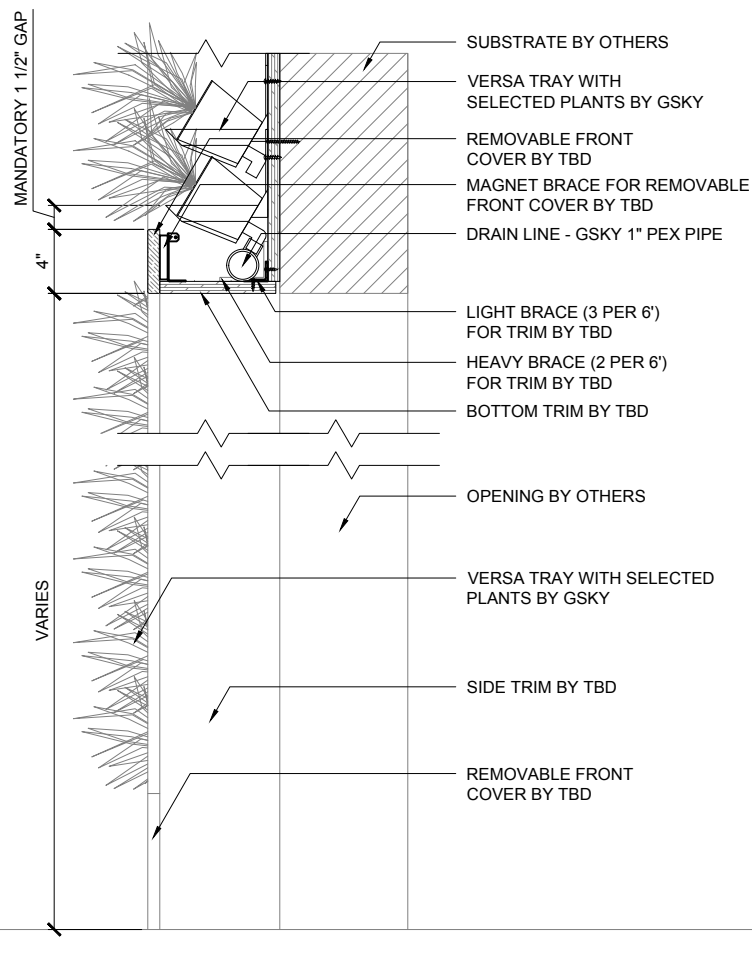
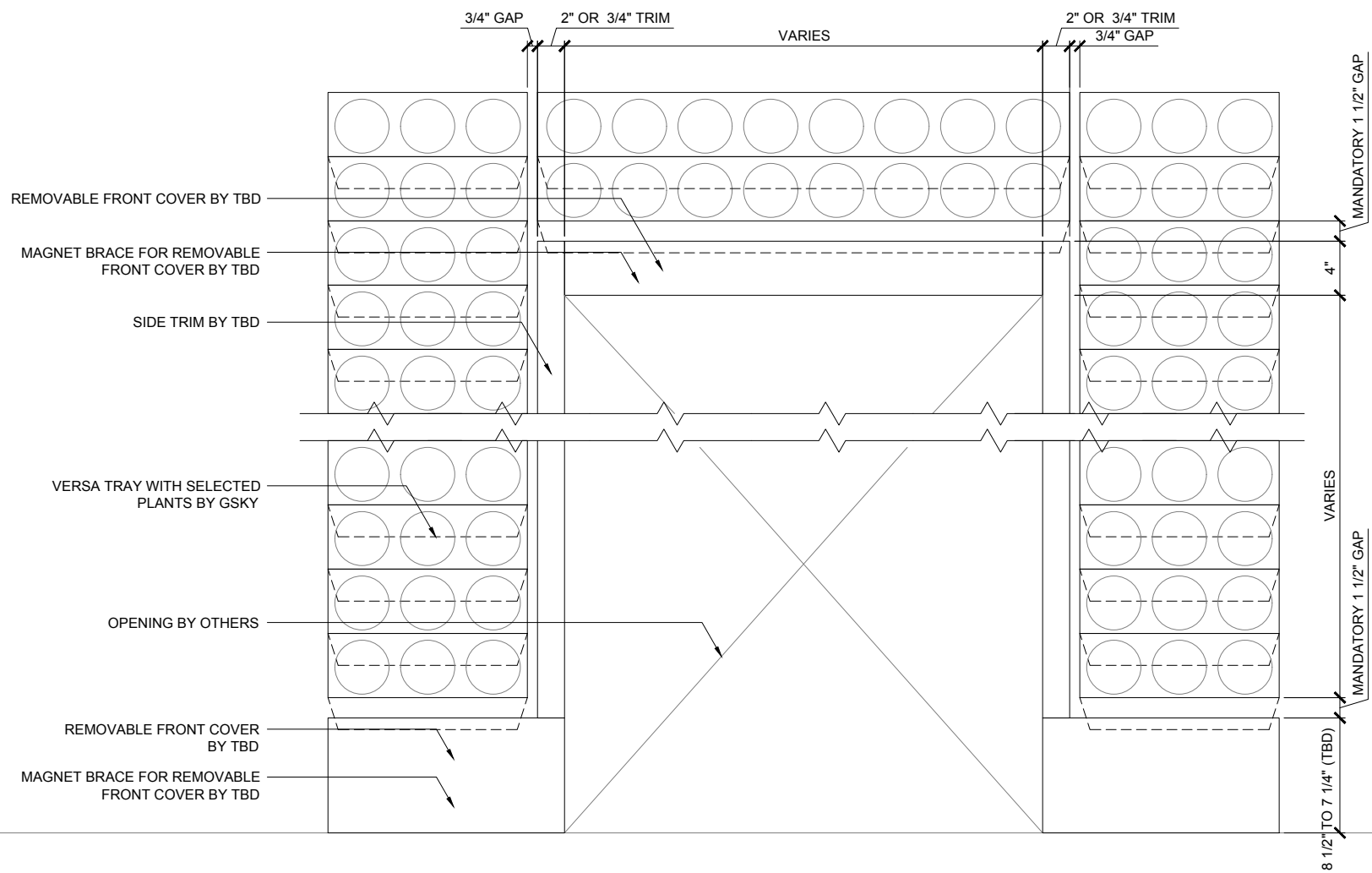

VERSA WALL[®]
 DETAIL - FLOOR LEVEL OPENING WITH BOTTOM TRIM
 VER. 1.1 11x17" (A3)

LIGHTING
 LED or Metal Halide Lights recommended

Duration
10-12 hrs/day
 Color Temp
4000-4500K
 Intensity
150fc / 1500 lux
(Even Flood)

MAINT. ACCESS
 Walls over 40' / 12m need additional considerations. See GSKy maintenance manual.

< 8'	OK		
< 13'	OK	OK	
> 13'		OK	OK

GVD2.0

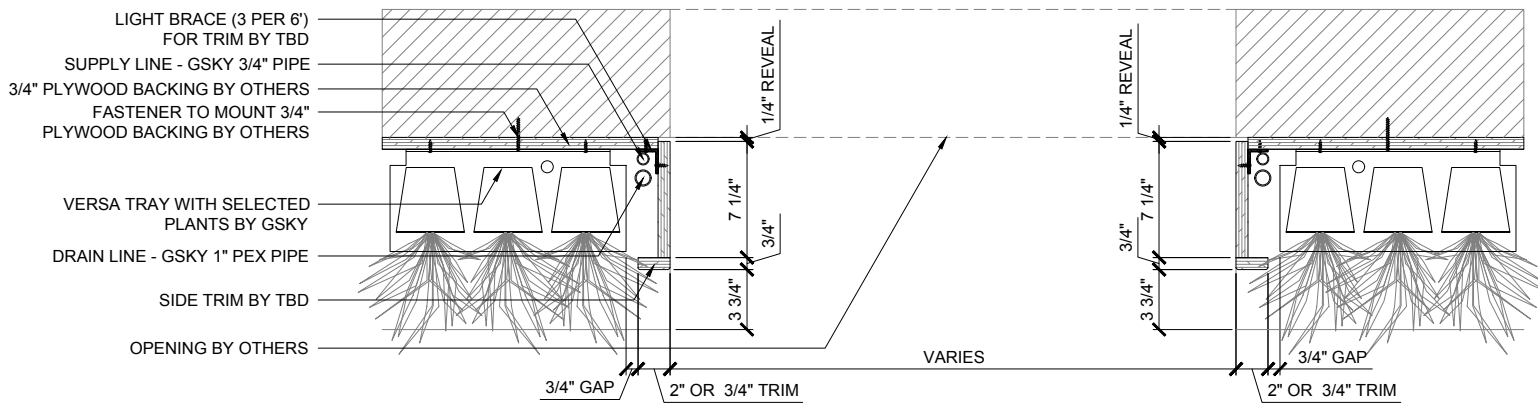
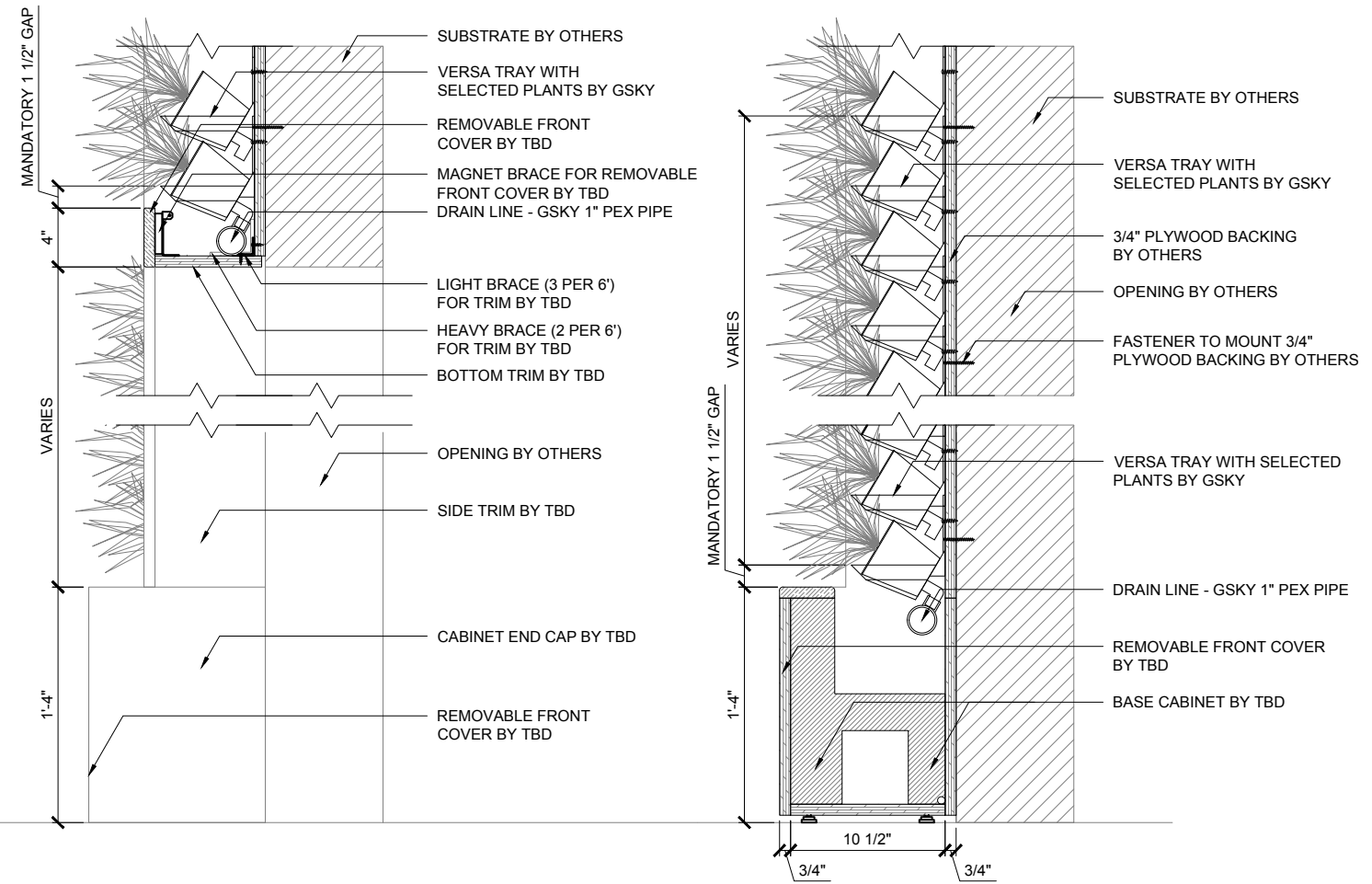
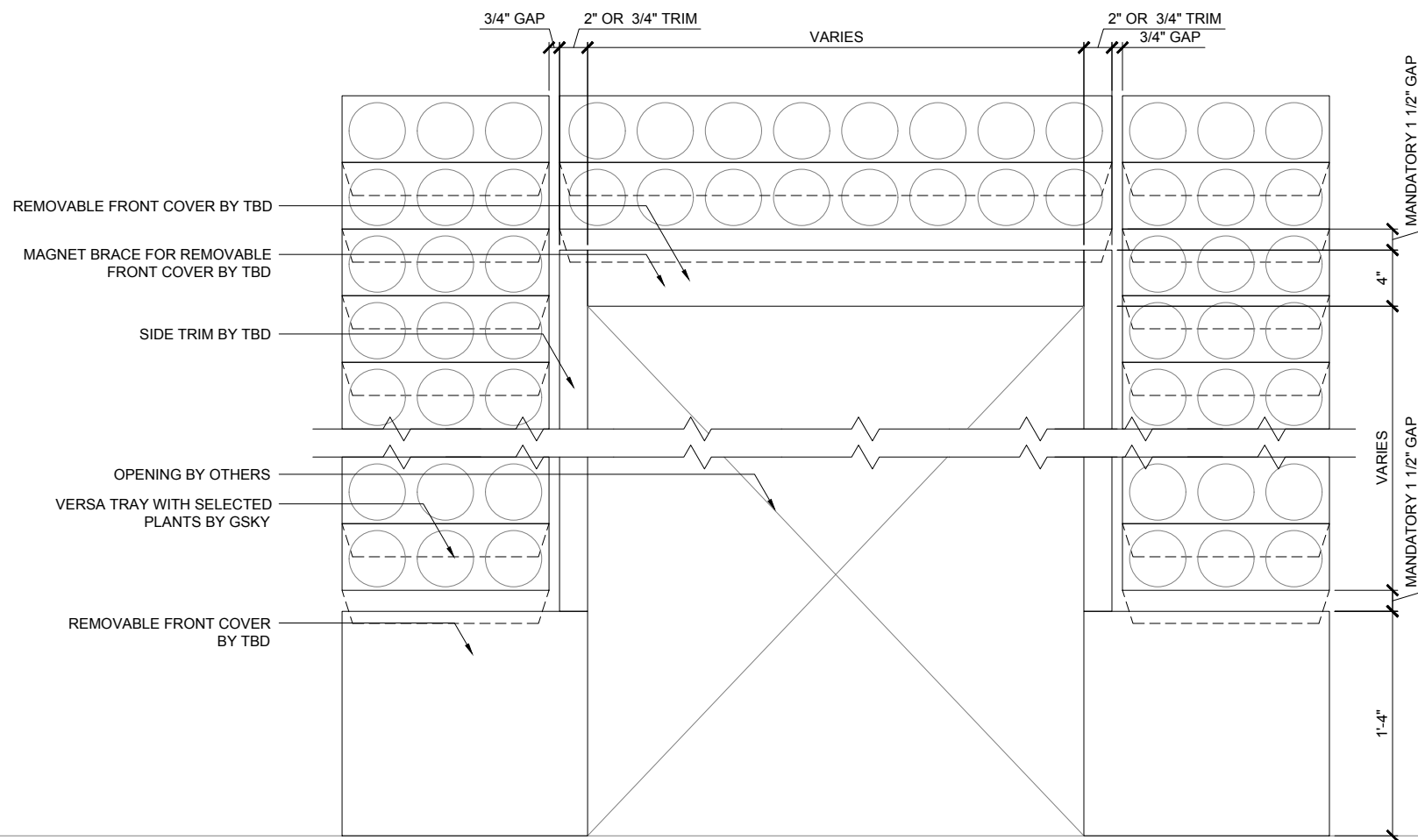

VERSA WALL®

DETAIL - FLOOR LEVEL OPENING WITH BASE CABINET

VER. 1.1

11x17" (A3)

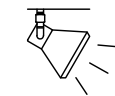

Duration
10-12 hrs/day
Color Temp
4000-4500K
Intensity
150fc / 1500 lux
(Even Flood)

LIGHTING
LED or Metal Halide Lights
recommended



< 8'	OK		
< 13'	OK	OK	
> 13'		OK	OK

MAINT. ACCESS
Walls over 40' / 12m need additional
considerations. See GSKy
maintenance manual.

GVD2.1

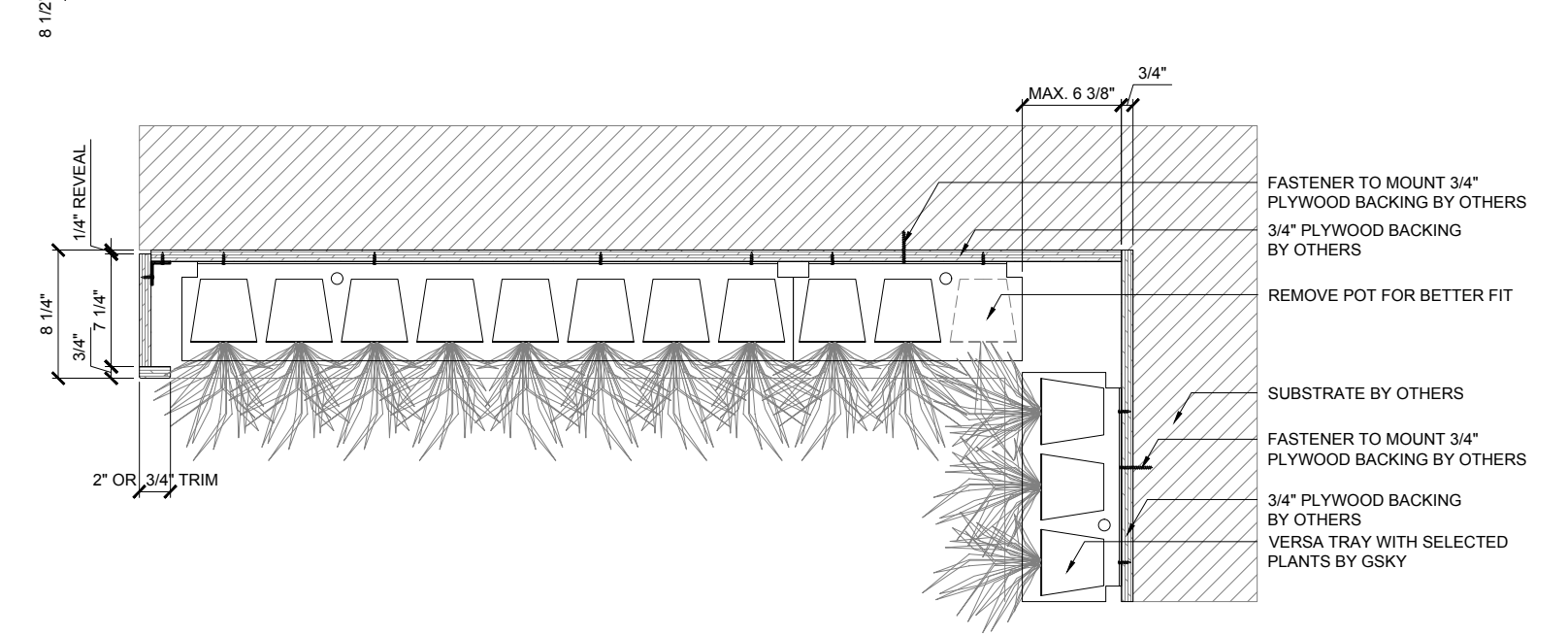
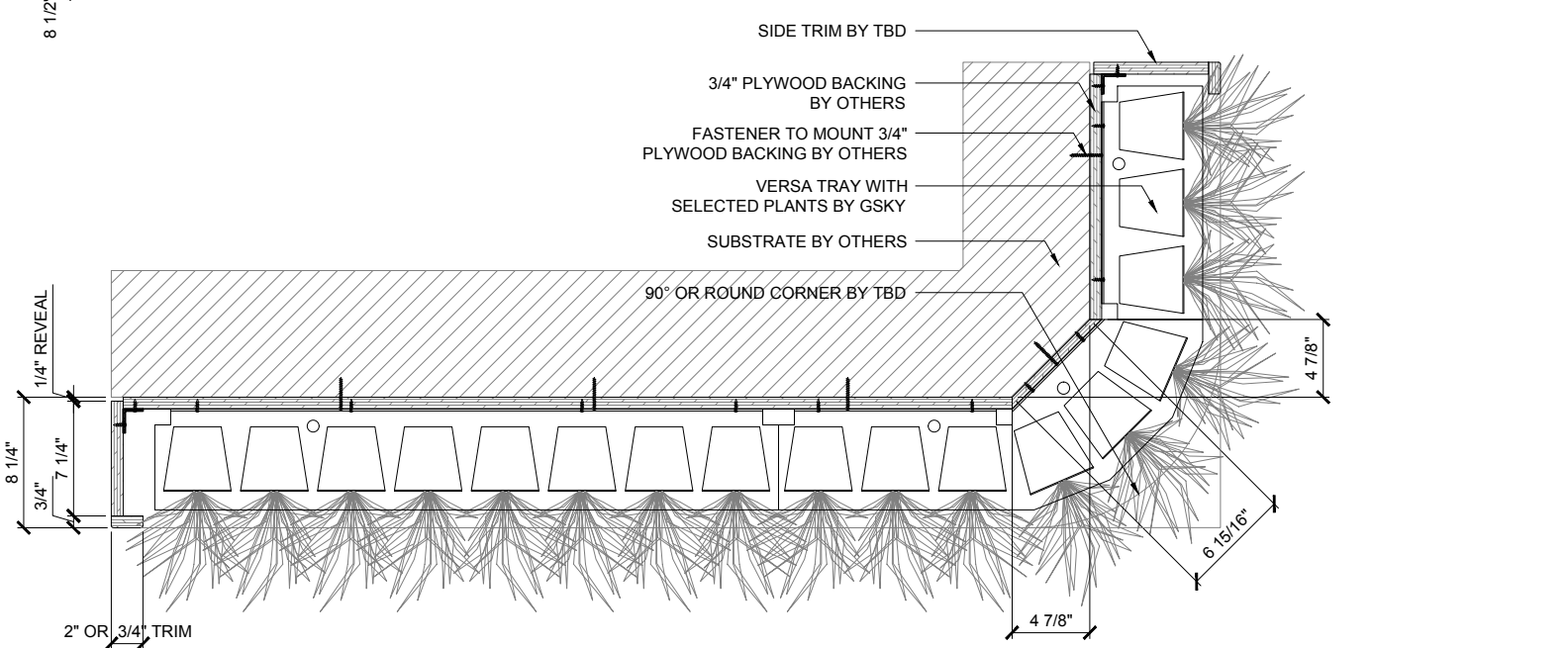
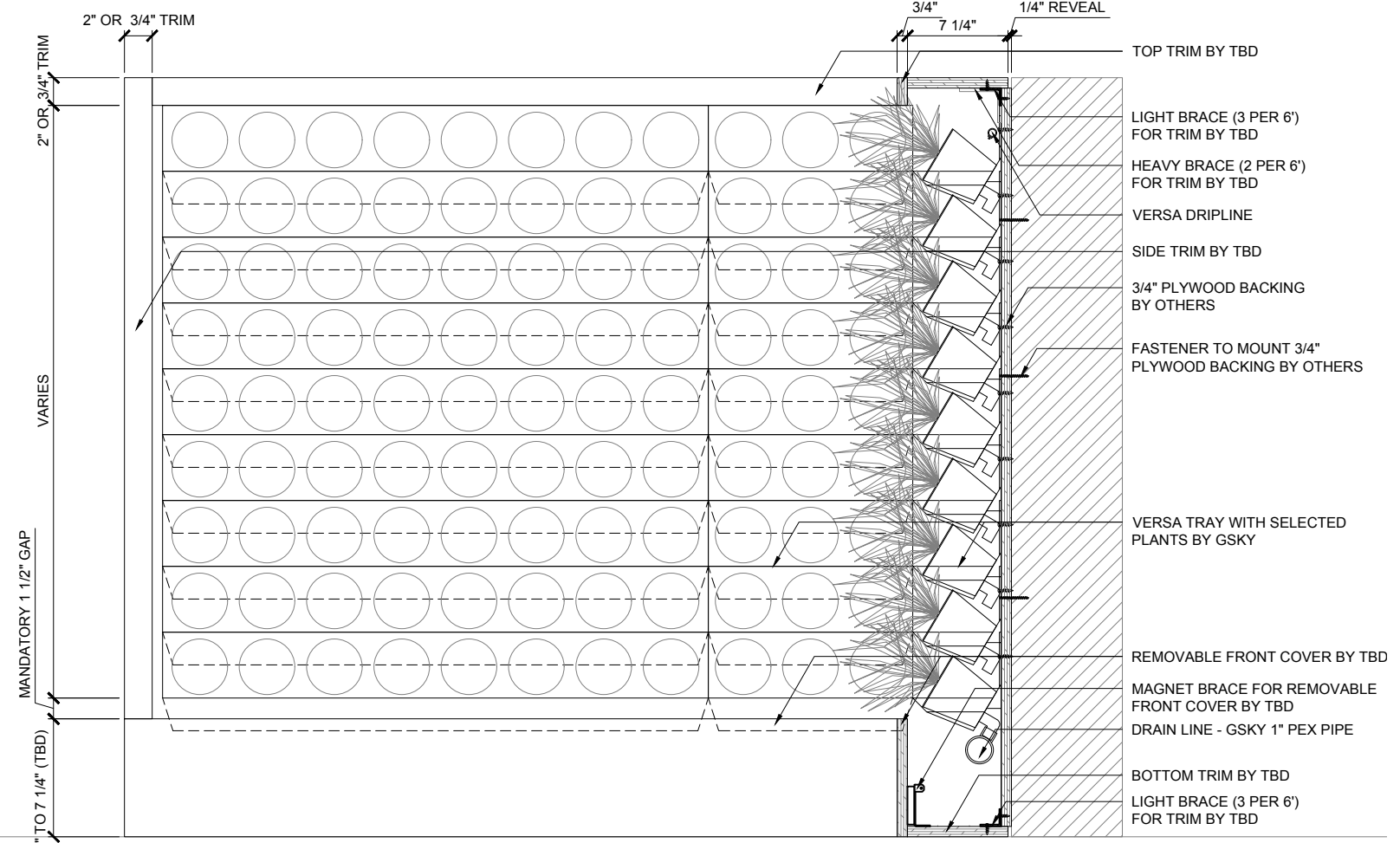
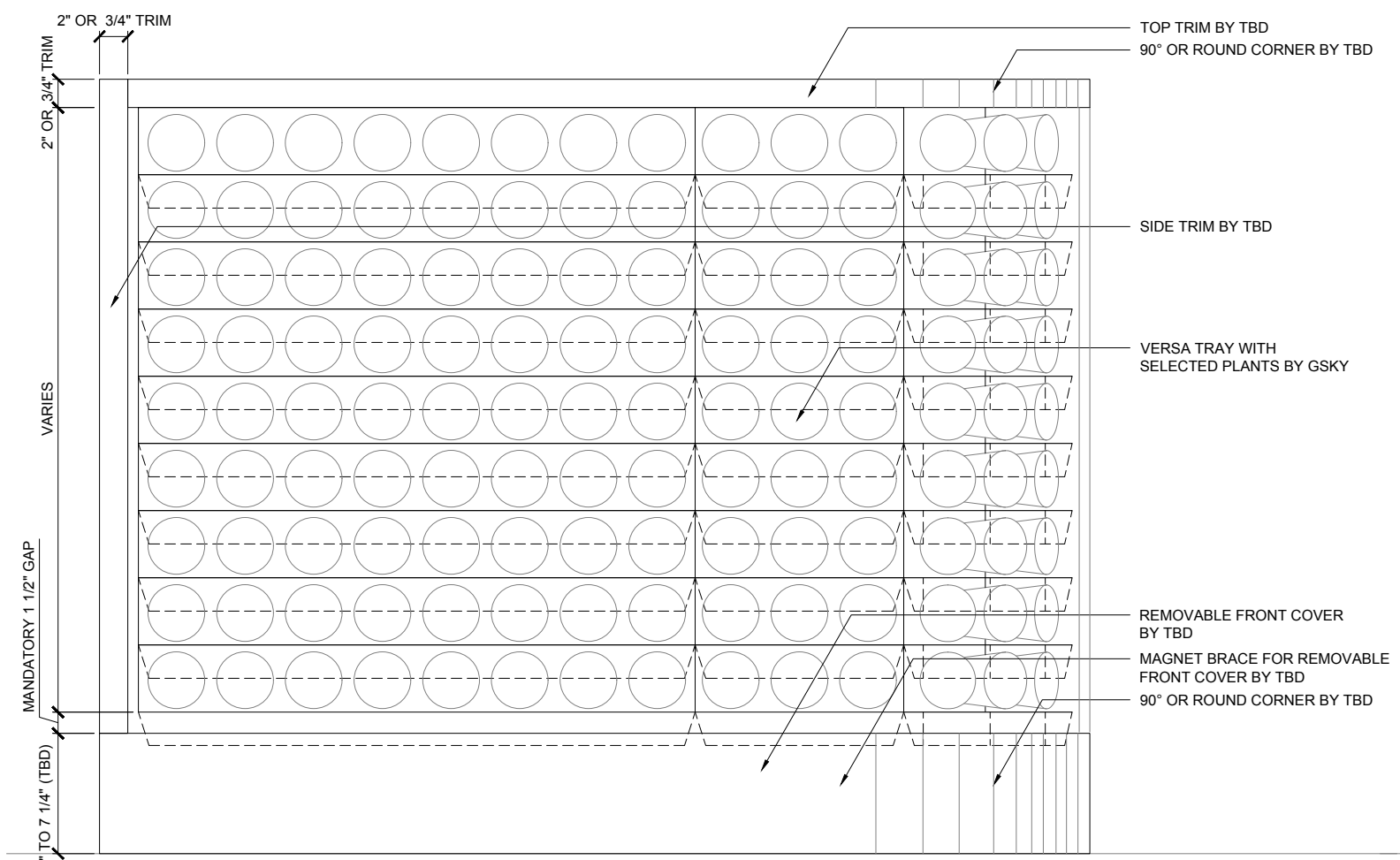

VERSA WALL®

DETAIL - INSIDE / OUTSIDE CORNER WITH BOTTOM TRIM

VER. 1.1 11x17" (A3)

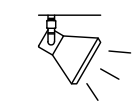

Duration
10-12 hrs/day
Color Temp
4000-4500K
Intensity
150fc / 1500 lux
(Even Flood)

LIGHTING
LED or Metal Halide Lights
recommended



< 8'	OK		
< 13'	OK	OK	
> 13'	OK	OK	OK

MAINT. ACCESS
Walls over 40' / 12m need additional
considerations. See GSKy
maintenance manual.

GVD3.0

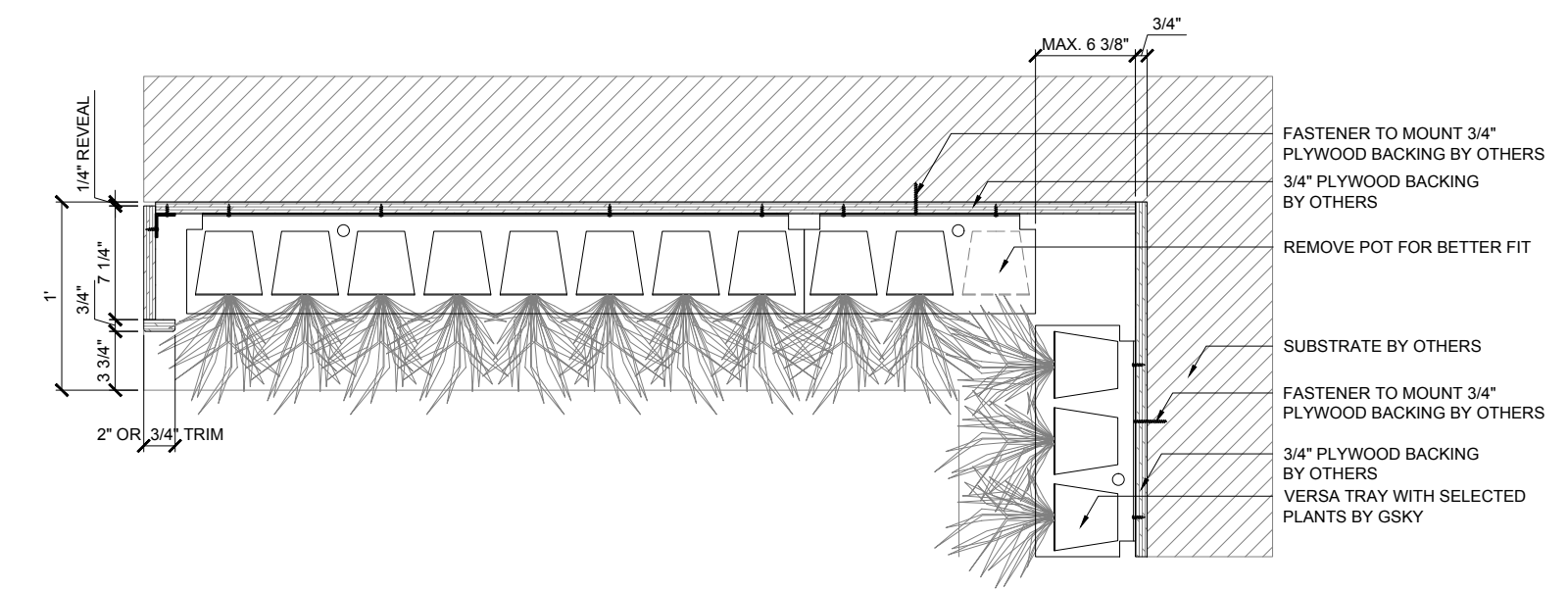
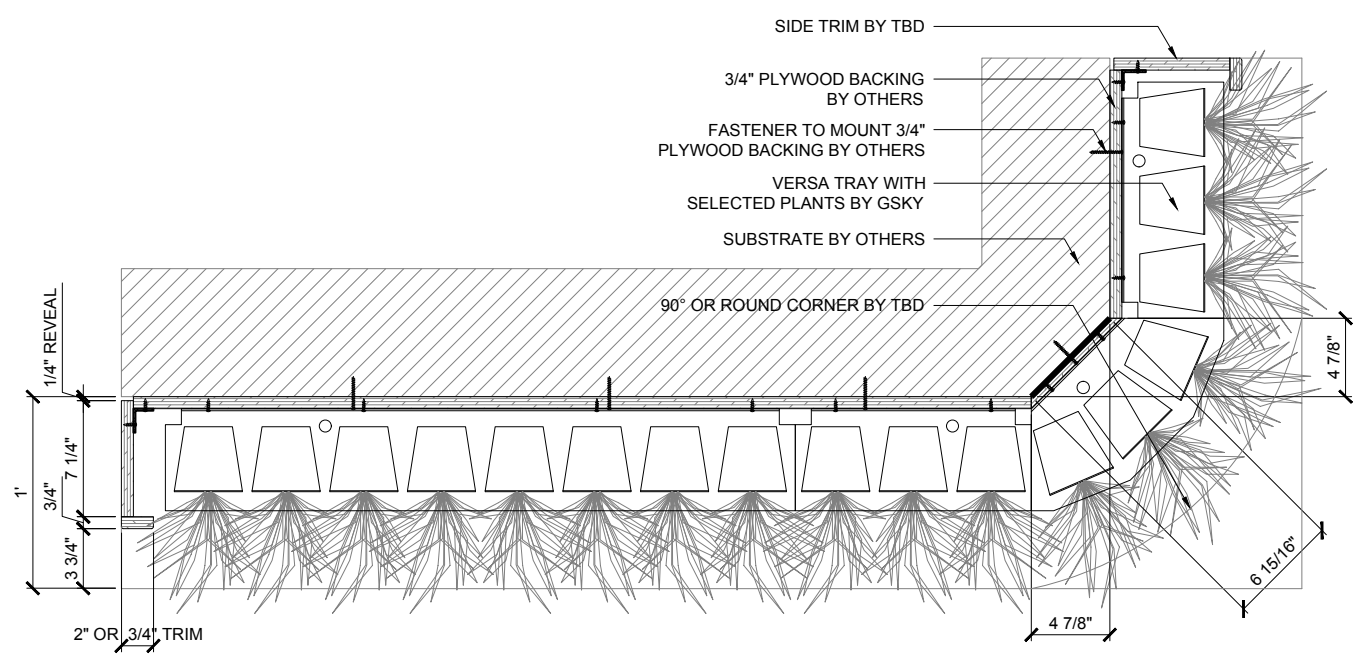
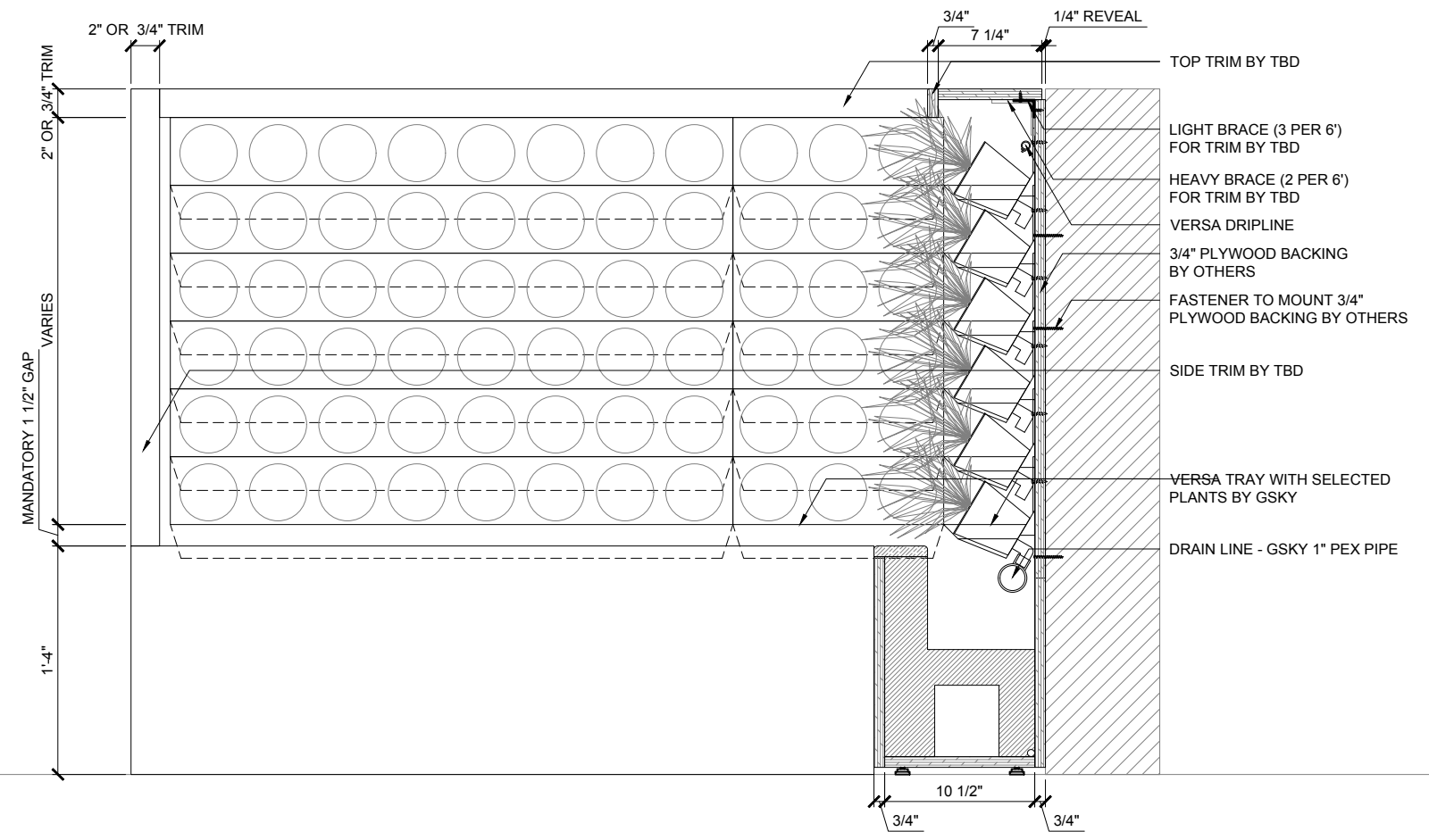
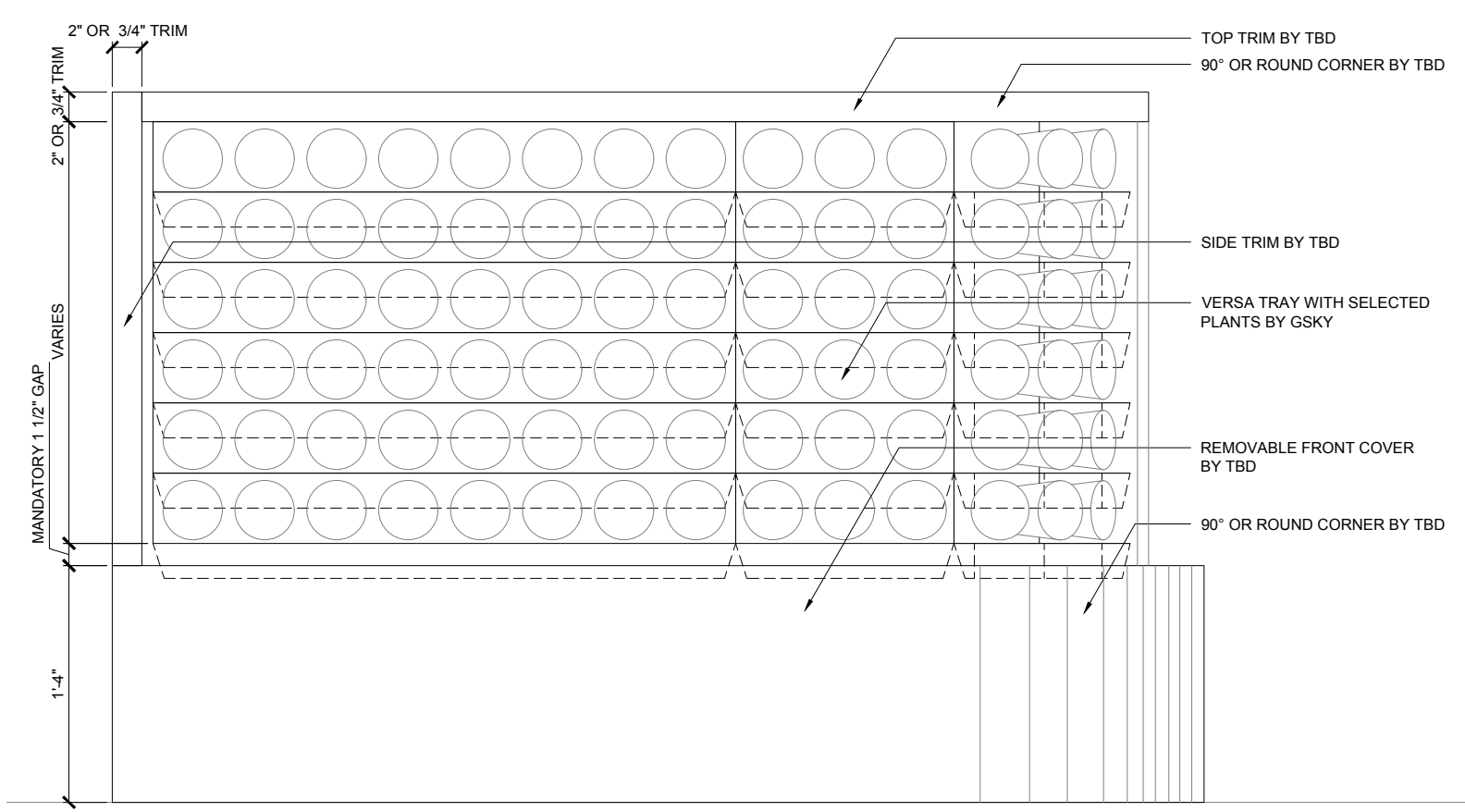

VERSA WALL[®]
 DETAIL - INSIDE / OUTSIDE CORNER WITH BASE CABINET
 VER. 1.1 11x17" (A3)

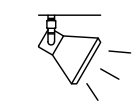

Duration
10-12 hrs/day
 Color Temp
4000-4500K
 Intensity
150fc / 1500 lux
(Even Flood)

LIGHTING
 LED or Metal Halide Lights
 recommended

< 8'	OK			
< 13'	OK	OK		
> 13'	OK	OK	OK	

MAINT. ACCESS
 Walls over 40' / 12m need additional
 considerations. See GSKy
 maintenance manual.

GVD3.1

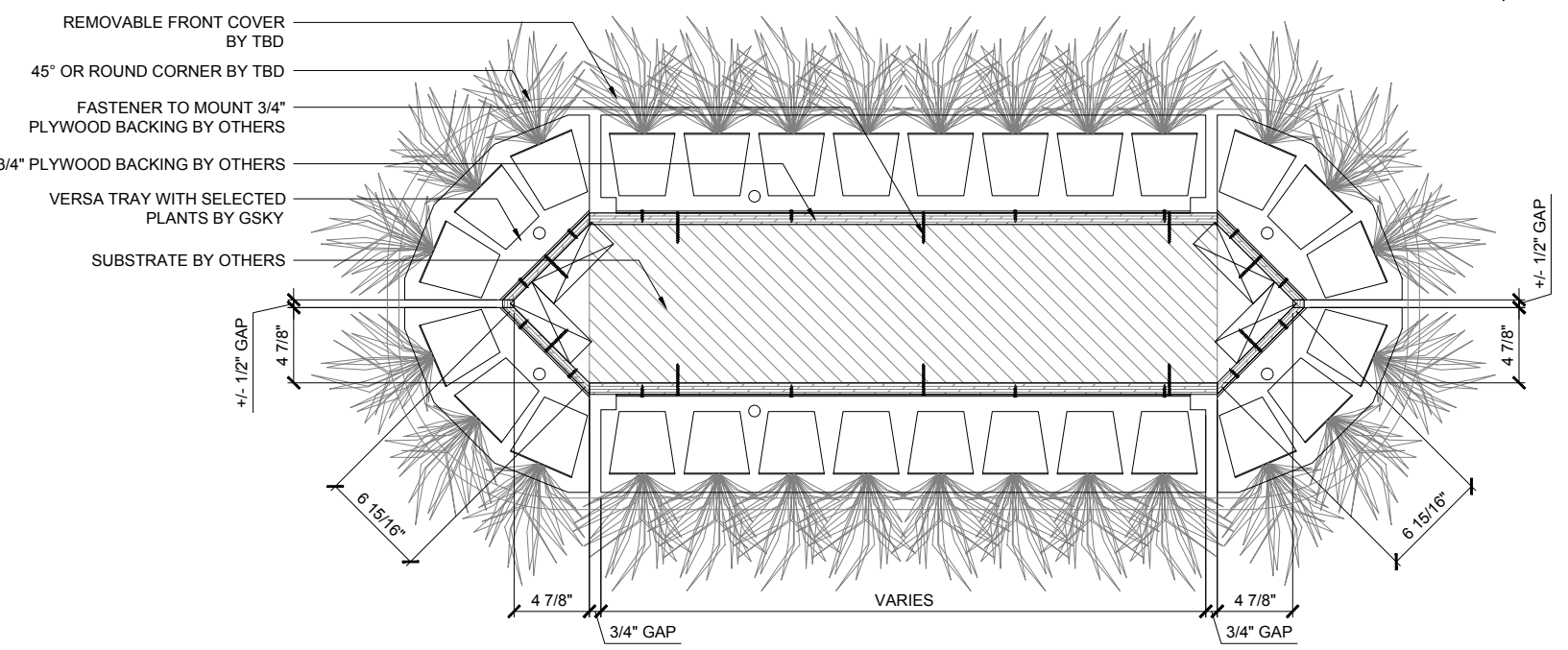
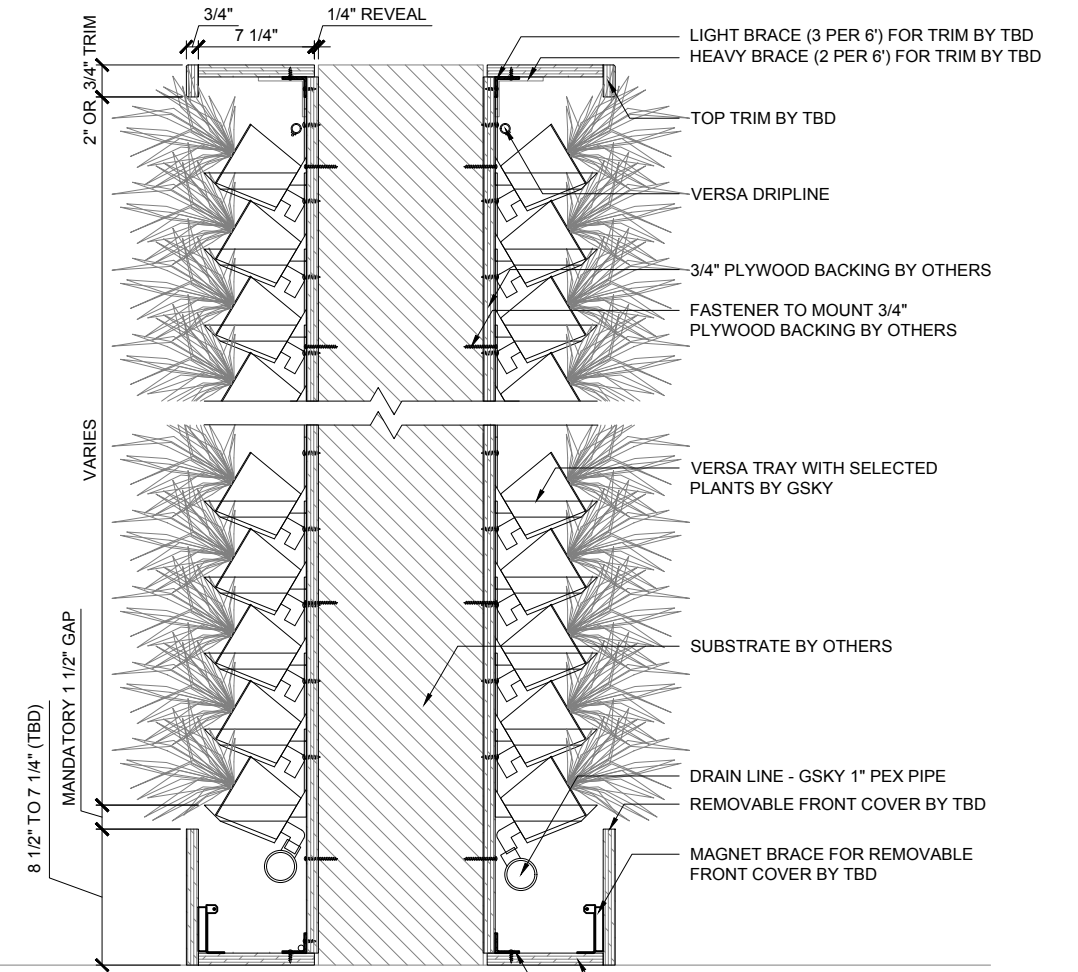
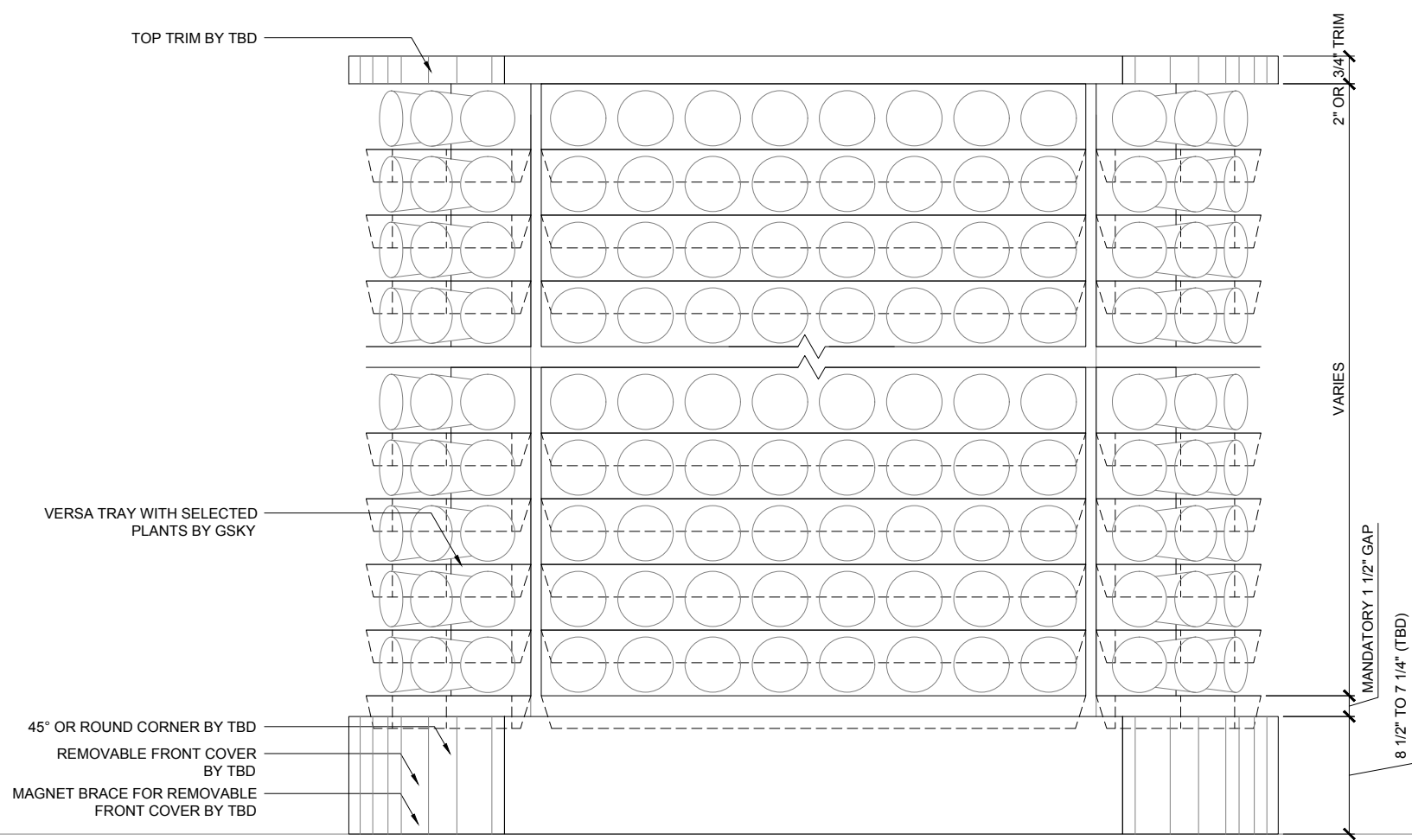

VERSA WALL[®]
 DETAIL - DOUBLE SIDED WALL WITH CORNER TRAY / BOTTOM TRIM
 VER. 1.1 11x17" (A3)

LIGHTING
 LED or Metal Halide Lights recommended

Duration
10-12 hrs/day
 Color Temp
4000-4500K
 Intensity
150fc / 1500 lux (Even Flood)

MAINT. ACCESS
 Walls over 40' / 12m need additional considerations. See GSKy maintenance manual.

< 8'	OK			
< 13'	OK	OK		
> 13'		OK	OK	OK

GVD4.0

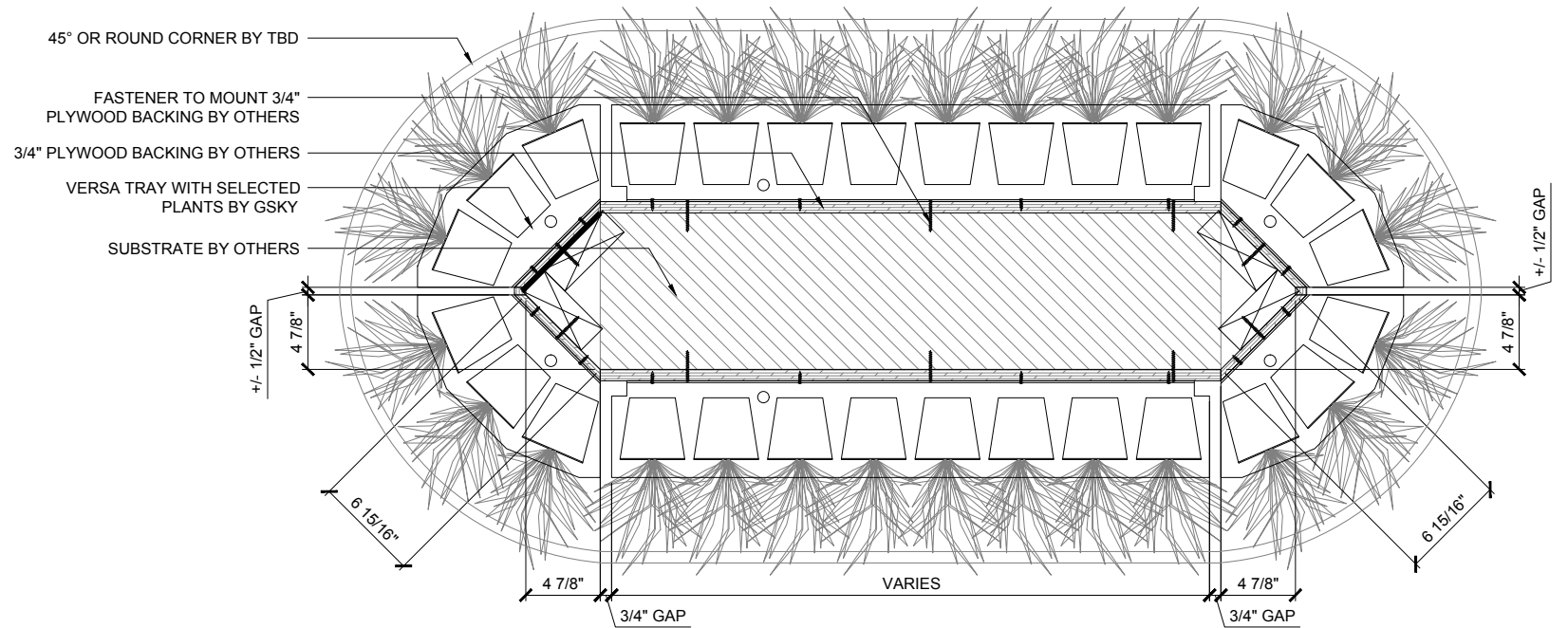
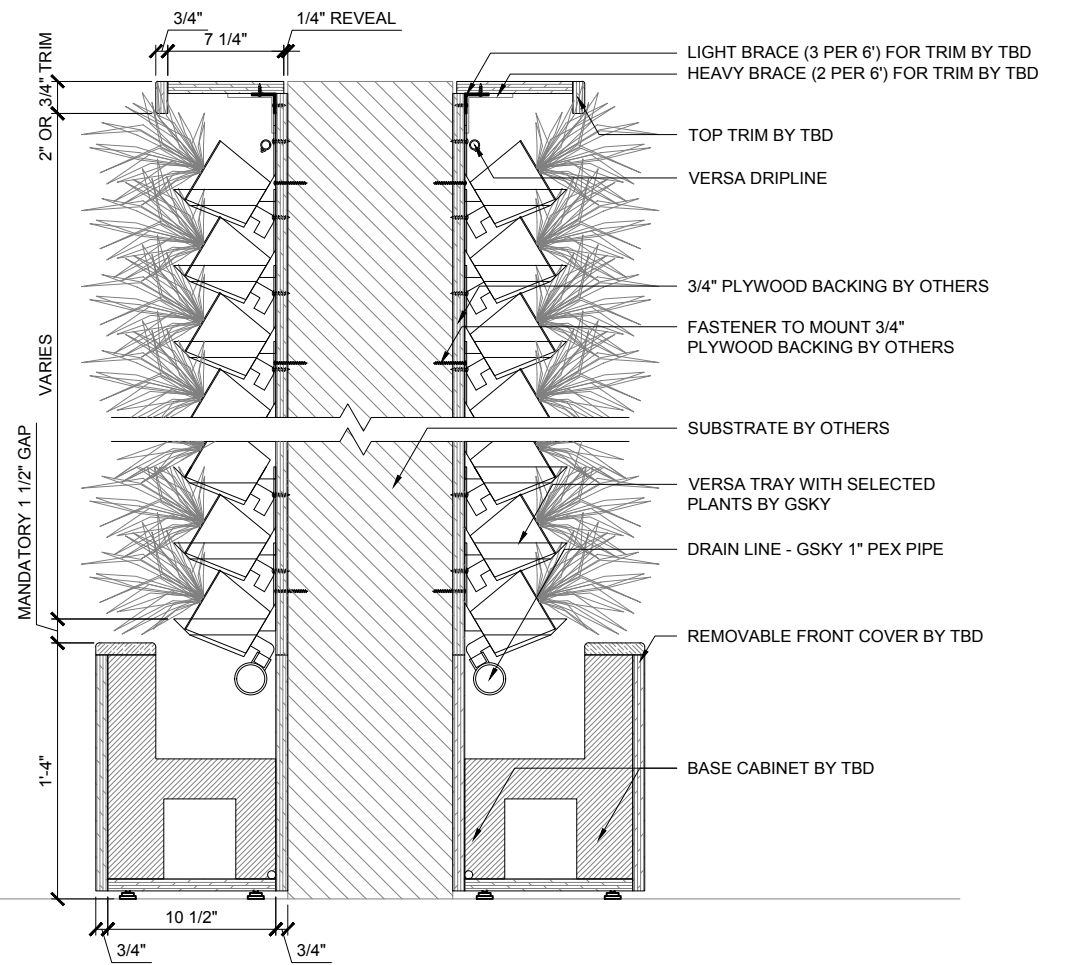
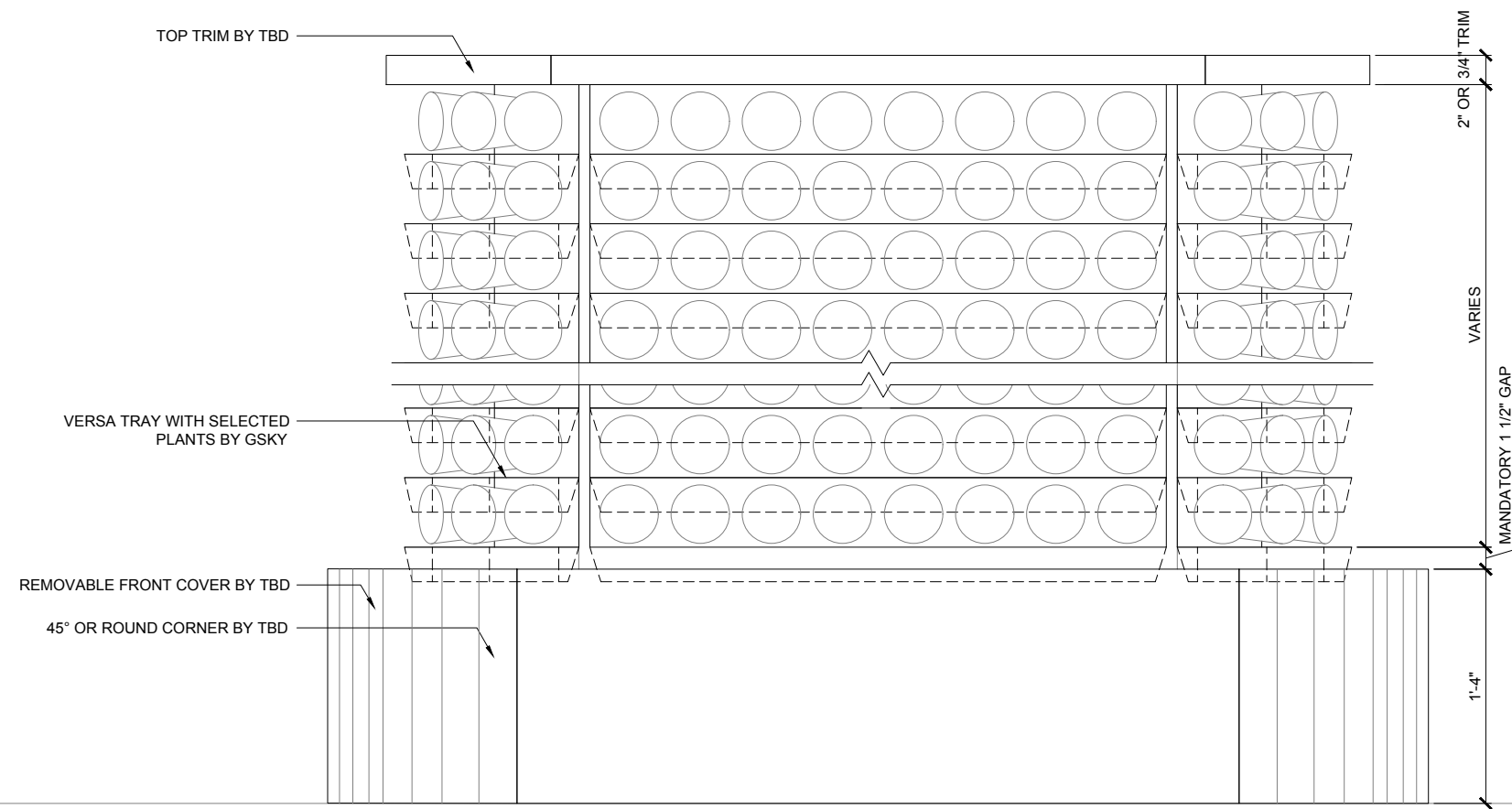

VERSA WALL®

DETAIL - DOUBLE SIDED WALL WITH CORNER TRAY / BASE CABINET

VER. 1.1

11x17" (A3)

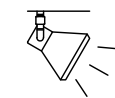

Duration
10-12 hrs/day
Color Temp
4000-4500K
Intensity
150fc / 1500 lux
(Even Flood)

LIGHTING
LED or Metal Halide Lights
recommended



< 8'	OK		
< 13'	OK	OK	
> 13'		OK	OK

MAINT. ACCESS
Walls over 40' / 12m need additional
considerations. See GSKy
maintenance manual.

GVD4.1

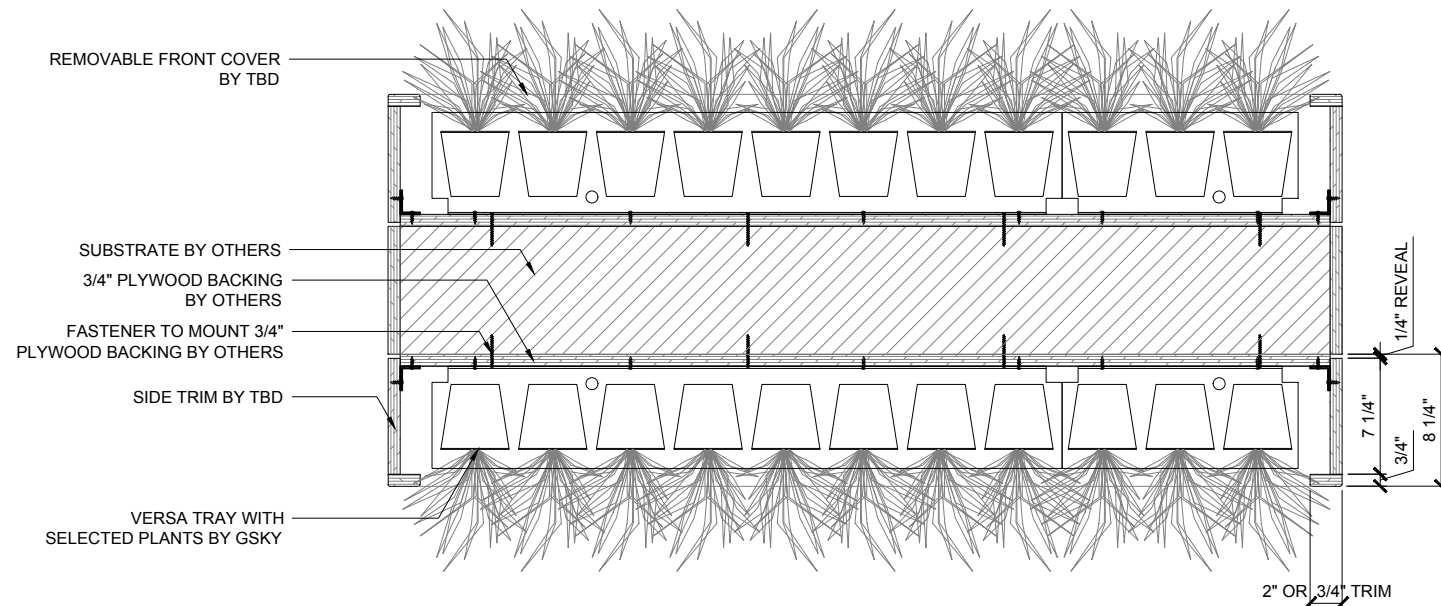
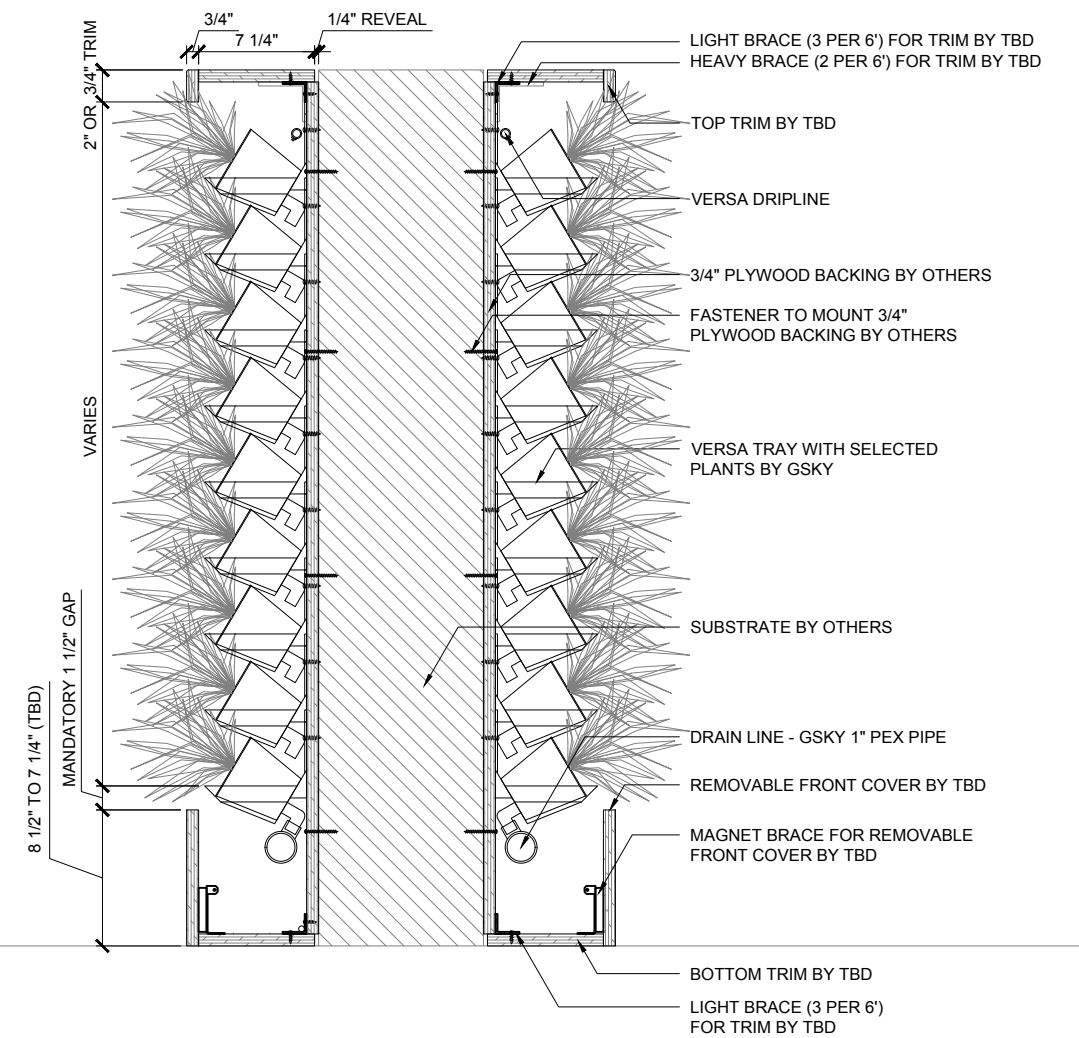
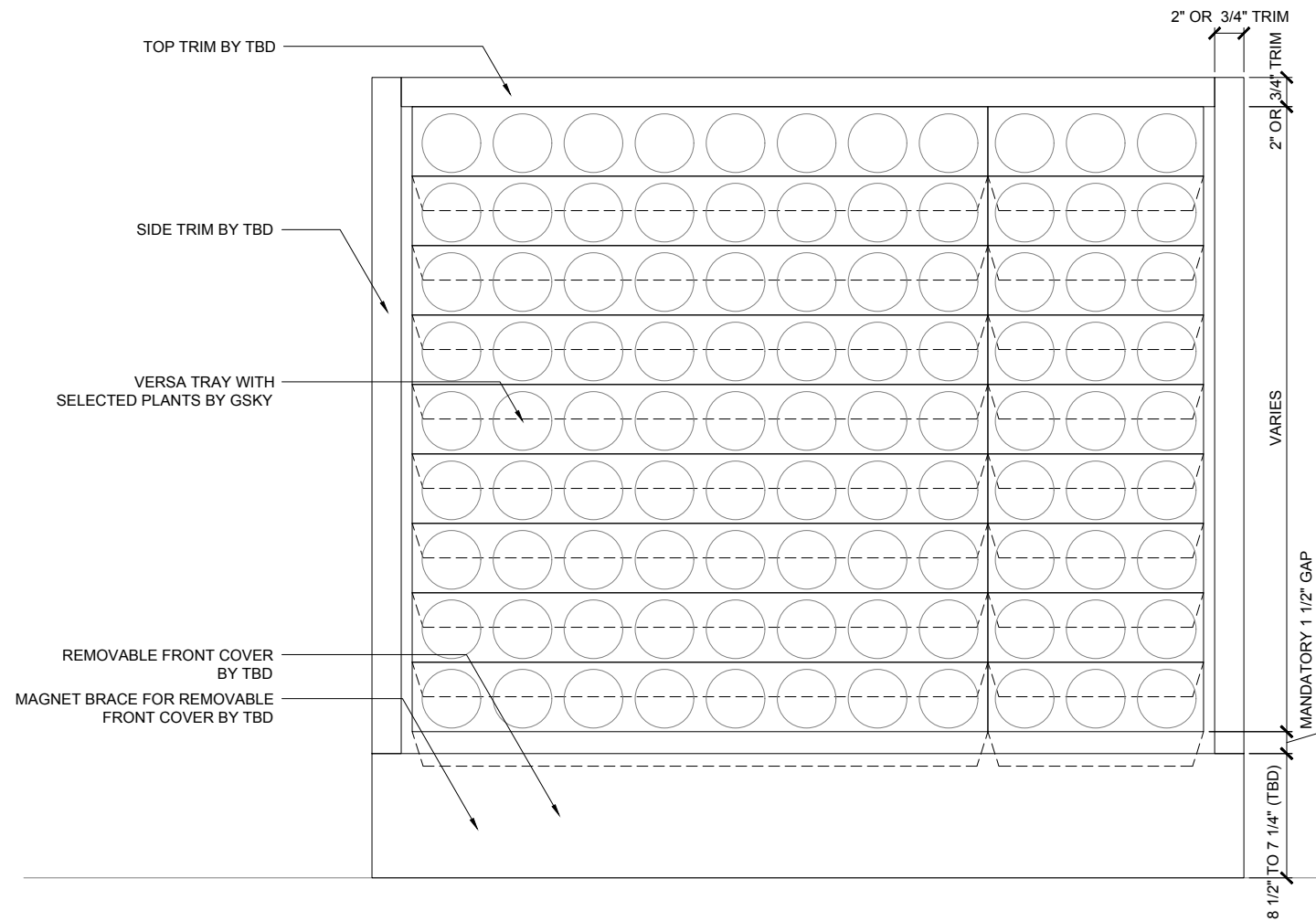

VERSA WALL®

DETAIL - DOUBLE SIDED WALL WITH SIDE TRIM / BOTTOM TRIM

VER. 1.1

11x17" (A3)

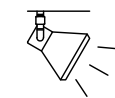

Duration
10-12 hrs/day
Color Temp
4000-4500K
Intensity
150fc / 1500 lux
(Even Flood)

LIGHTING
LED or Metal Halide Lights
recommended



< 8'	OK		
< 13'	OK	OK	
> 13'		OK	OK

MAINT. ACCESS
Walls over 40' / 12m need additional
considerations. See GSKy
maintenance manual.

GVD4.2

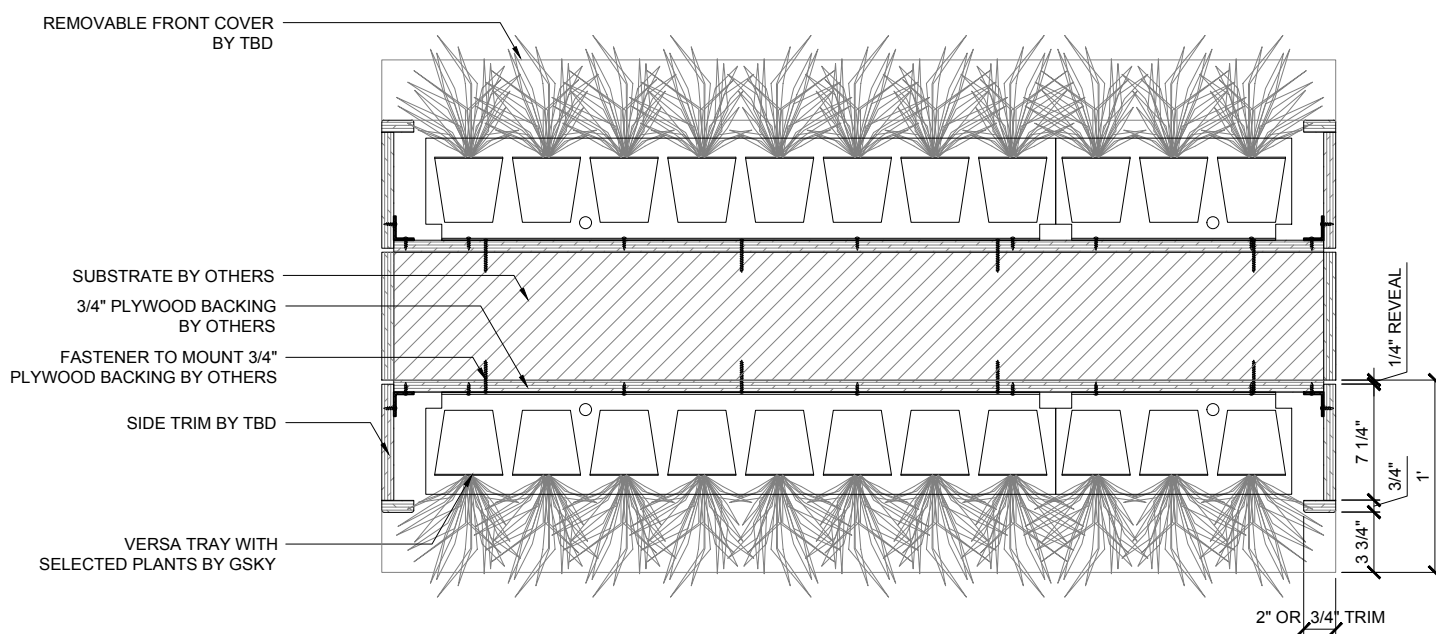
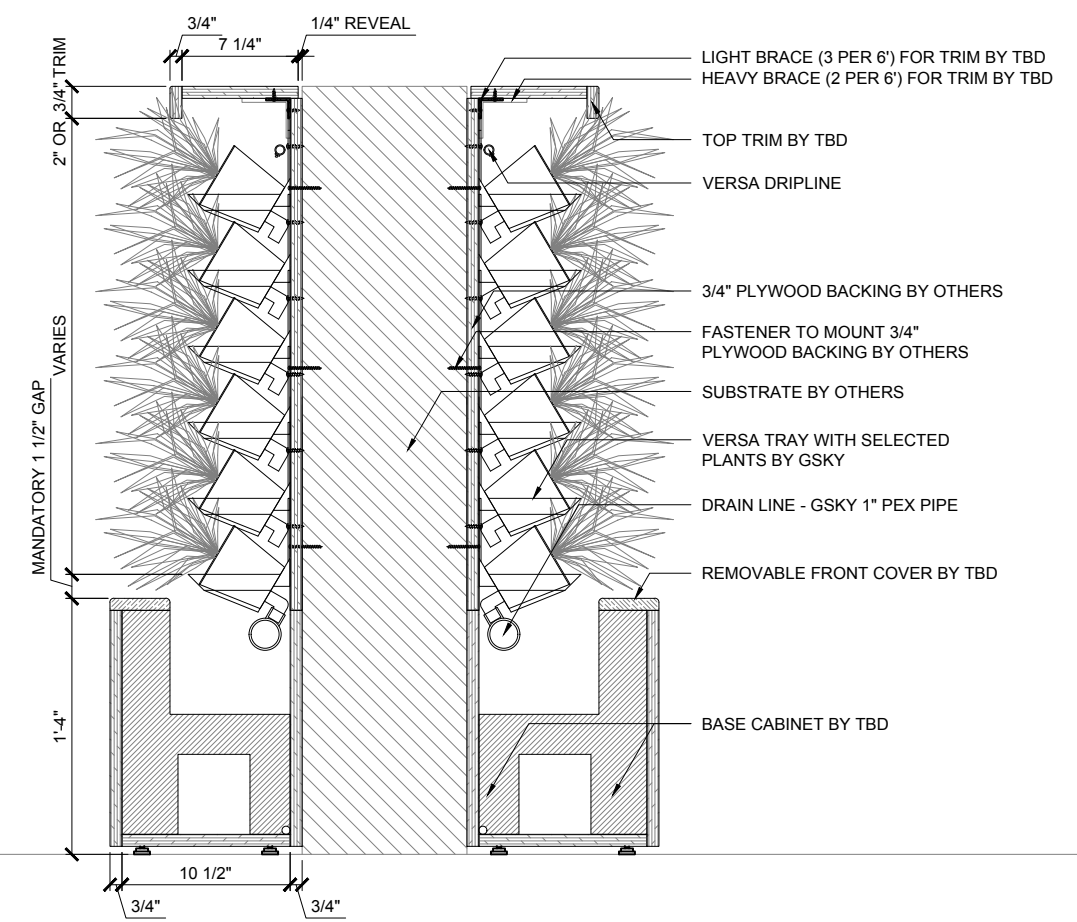
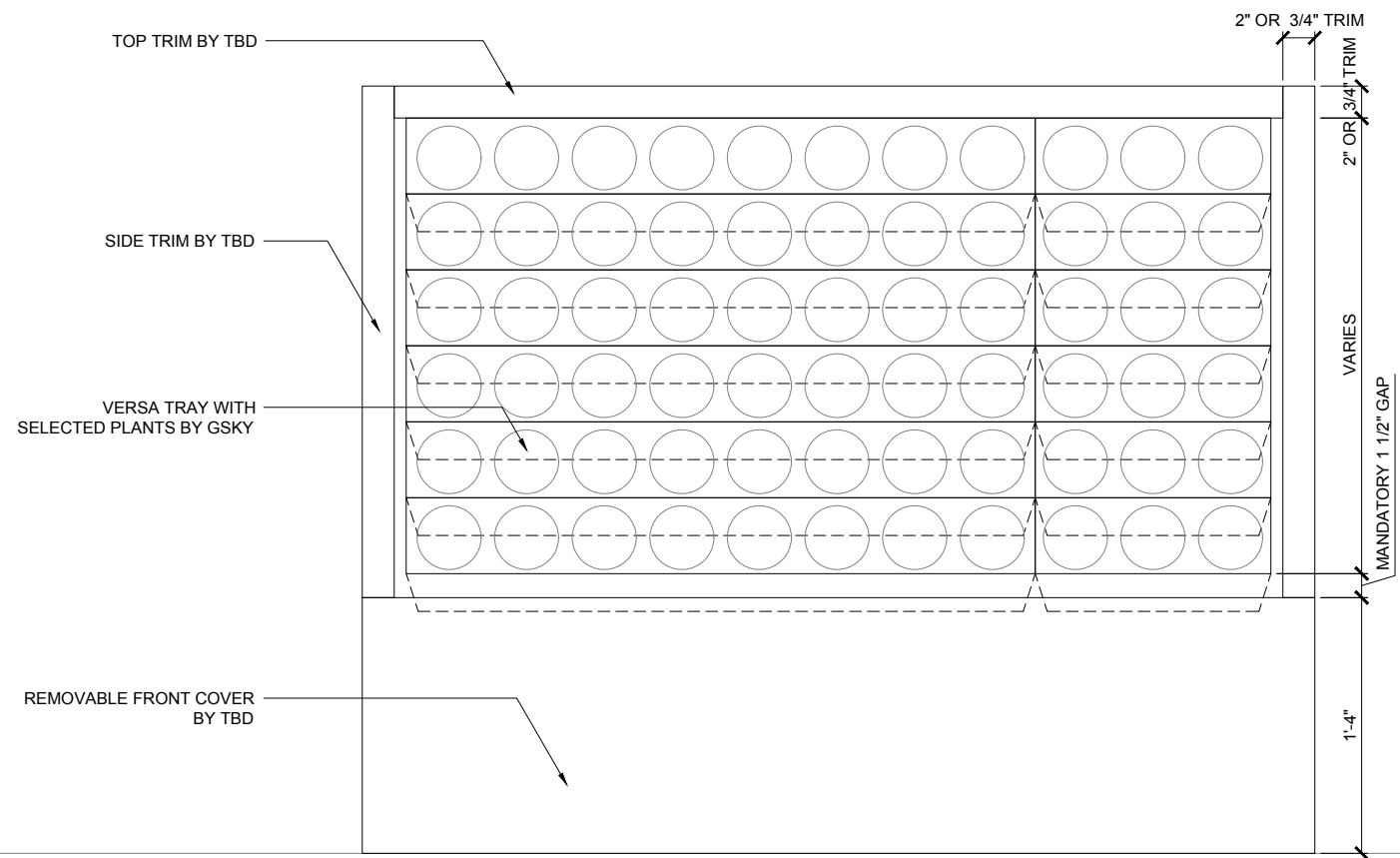

VERSA WALL®

DETAIL - DOUBLE SIDED WALL WITH SIDE TRIM / BASE CABINET

VER. 1.1

11x17" (A3)

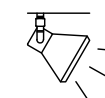

Duration
10-12 hrs/day
Color Temp
4000-4500K
Intensity
150fc / 1500 lux
(Even Flood)

LIGHTING
LED or Metal Halide Lights
recommended

< 8'	OK			
< 13'	OK	OK		
> 13'		OK	OK	OK

MAINT. ACCESS
Walls over 40' / 12m need additional
considerations. See GSKy
maintenance manual.

GVD4.3

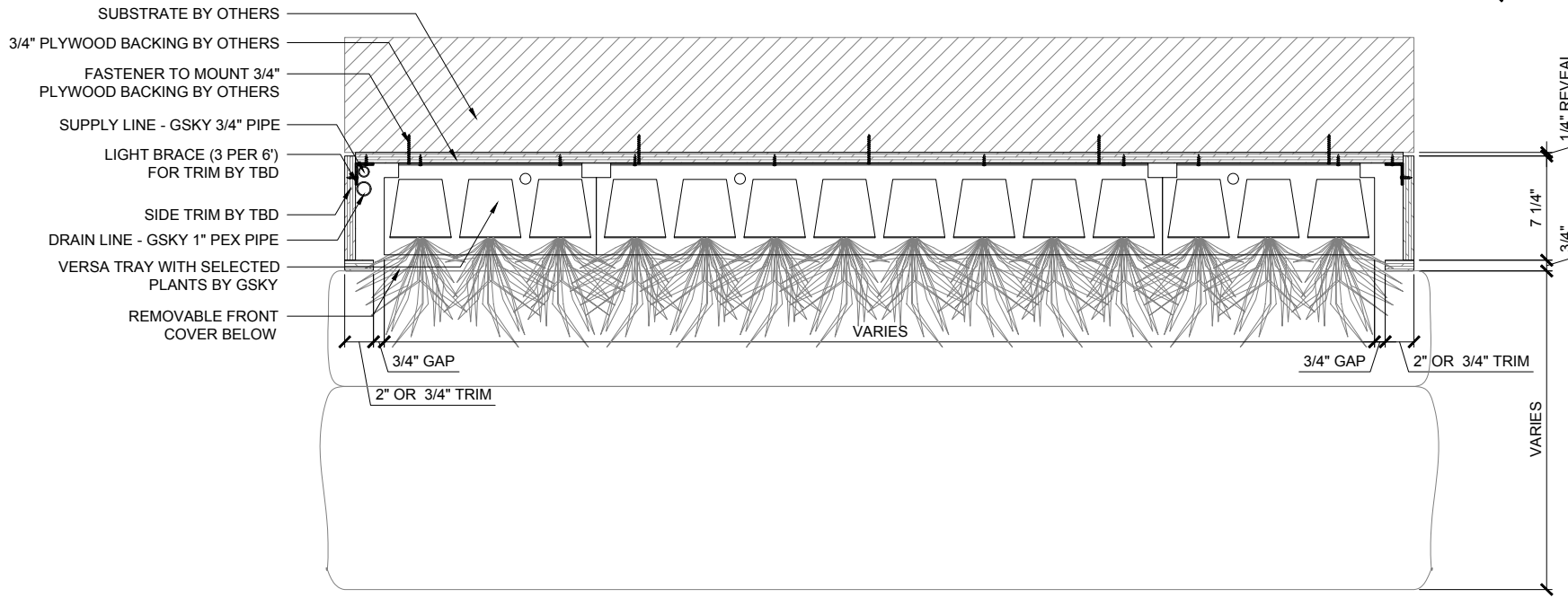
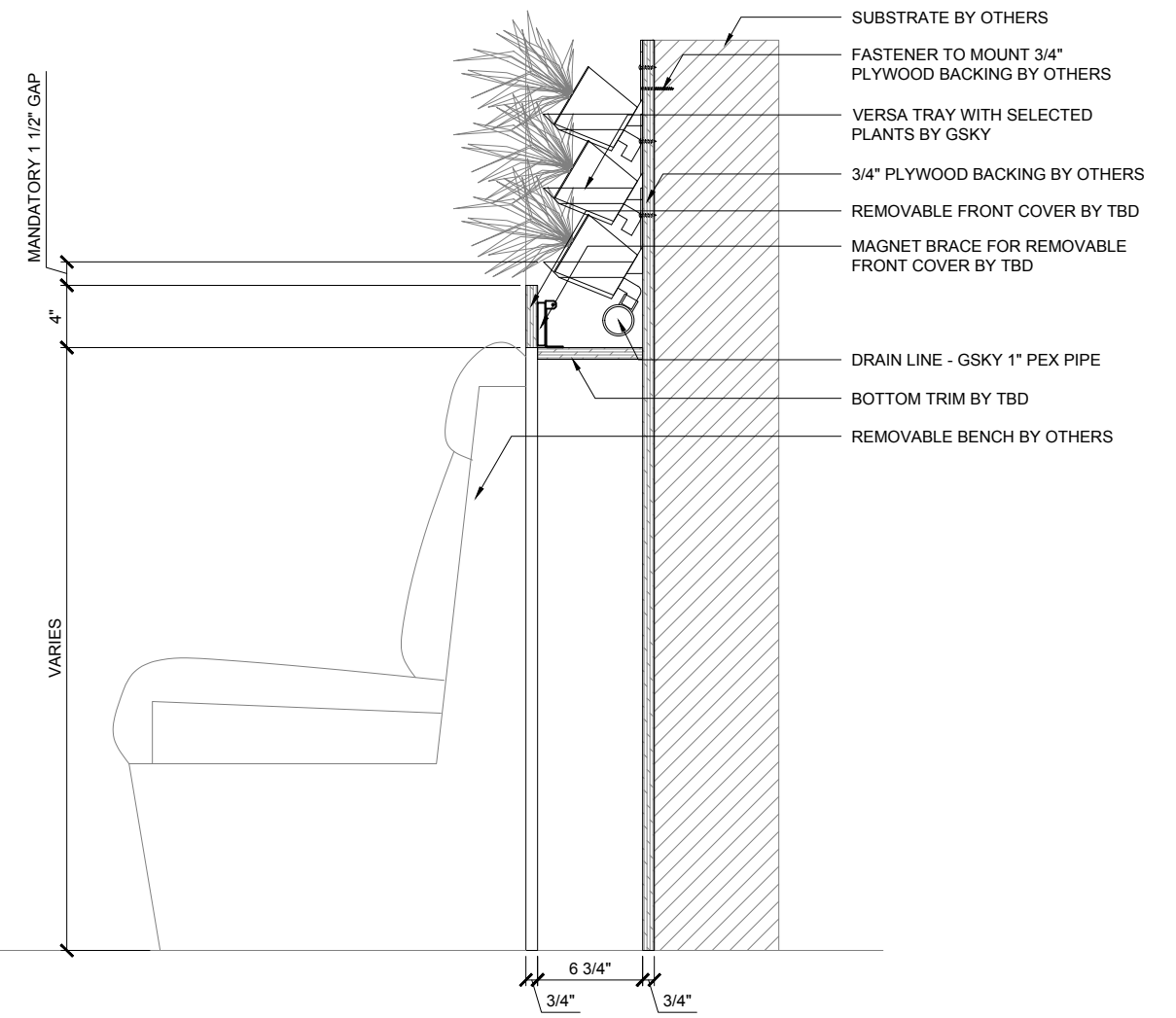
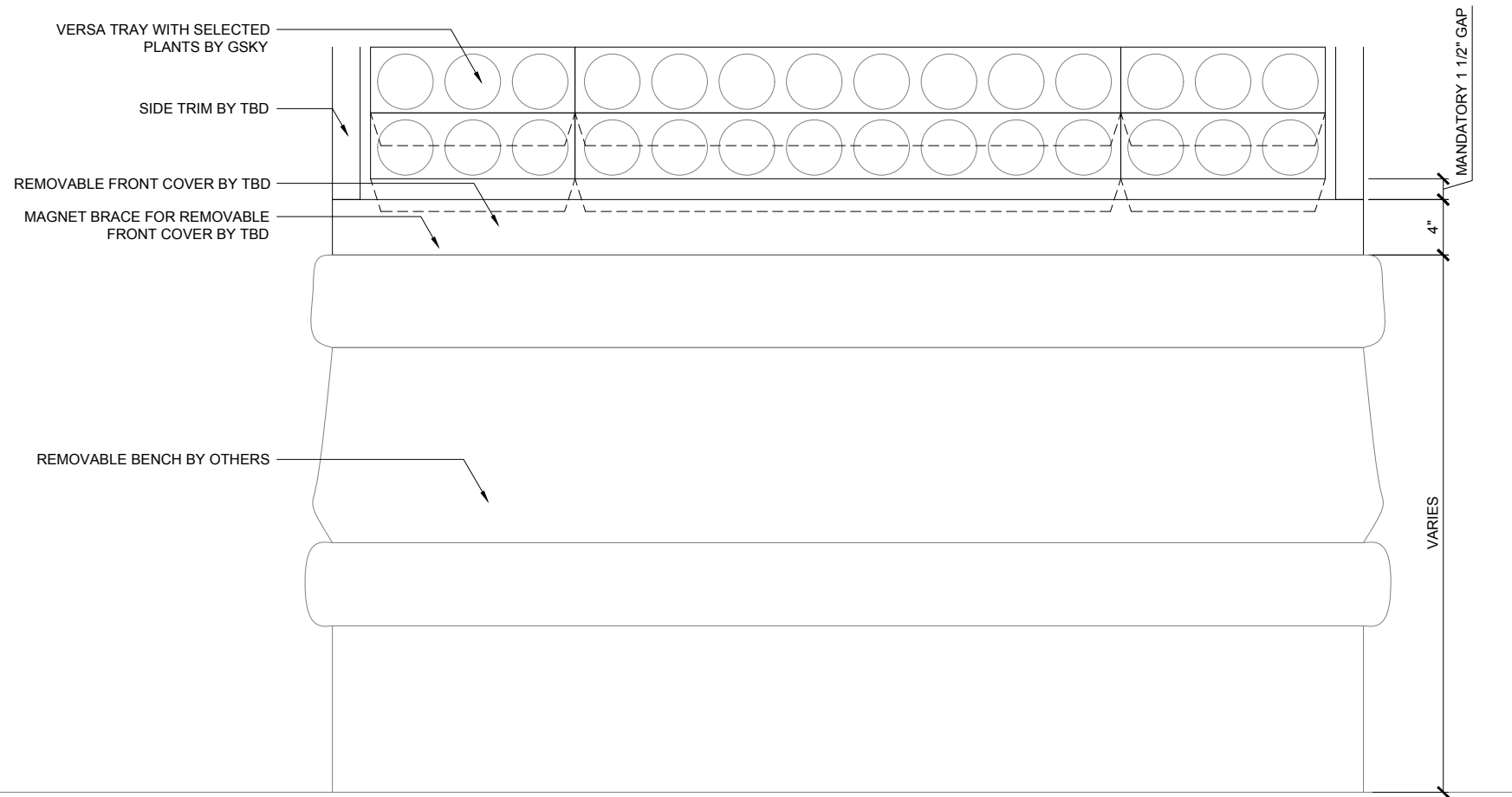

MAINTENANCE ACCESS MUST BE CONSIDERED IF OBSTACLE IS NOT REMOVABLE



VERSA WALL®

DETAIL - OBSTACLE BELOW GREEN WALL

VER. 1.1 11x17" (A3)

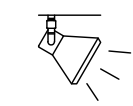

Duration
10-12 hrs/day

Color Temp
4000-4500K

Intensity
150fc / 1500 lux
(Even Flood)

LIGHTING
LED or Metal Halide Lights recommended

< 8'	OK			
< 13'	OK	OK		
> 13'		OK	OK	OK

MAINT. ACCESS
Walls over 40' / 12m need additional considerations. See GSKy maintenance manual.

GVD5.0

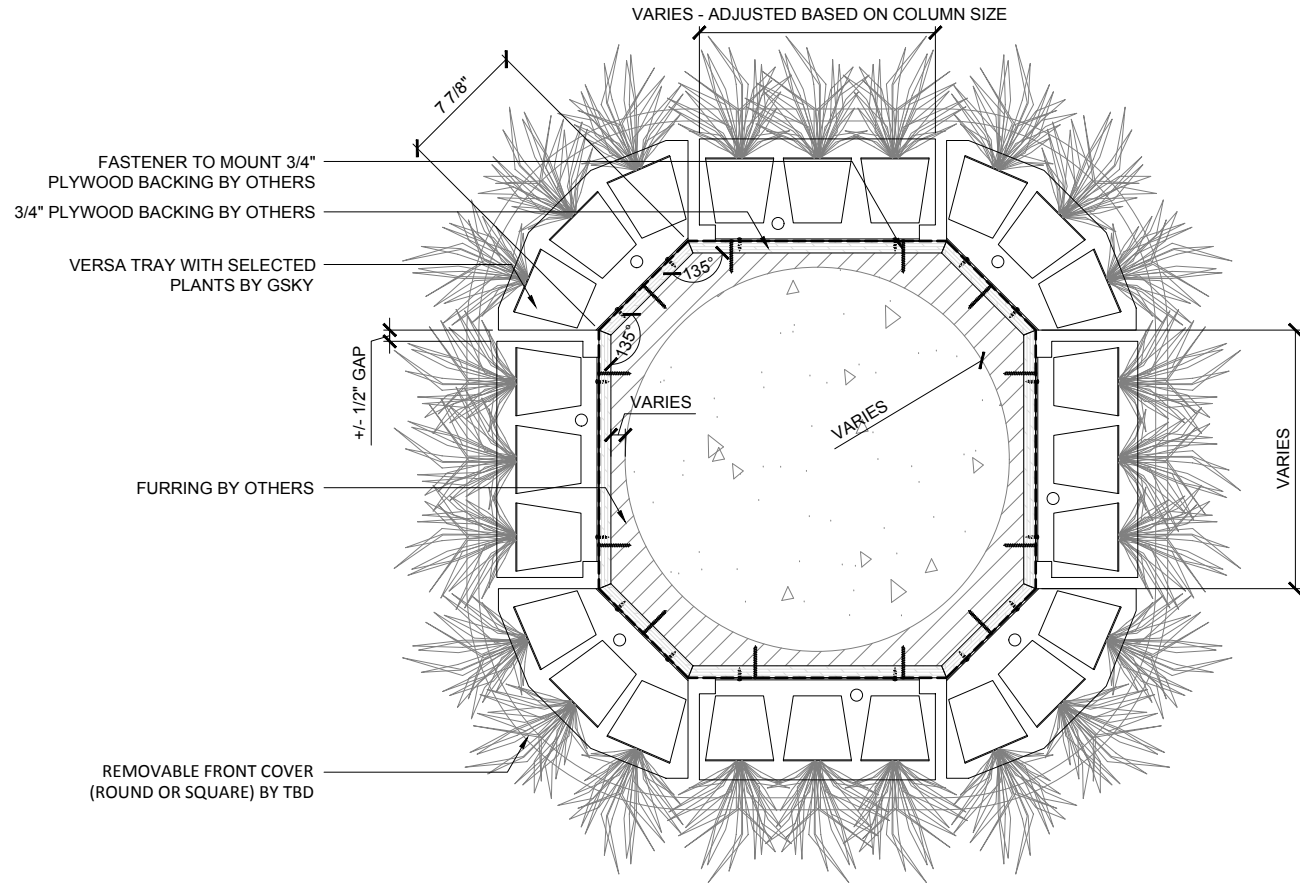
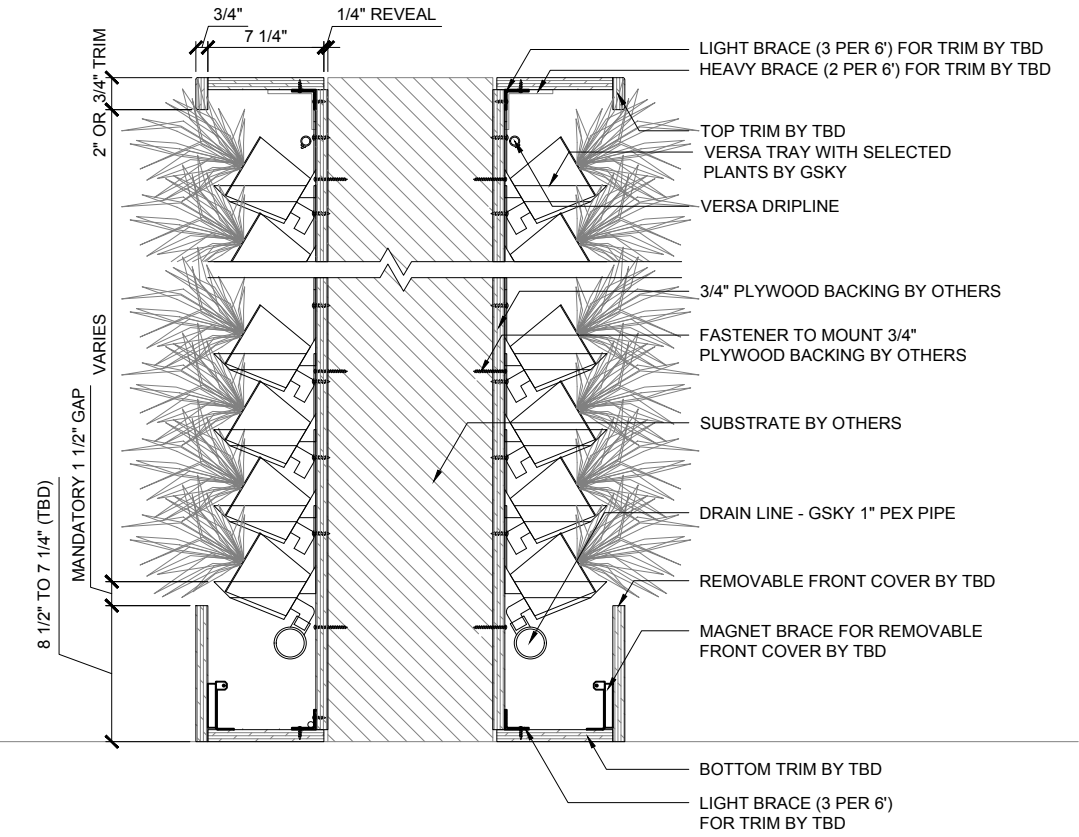
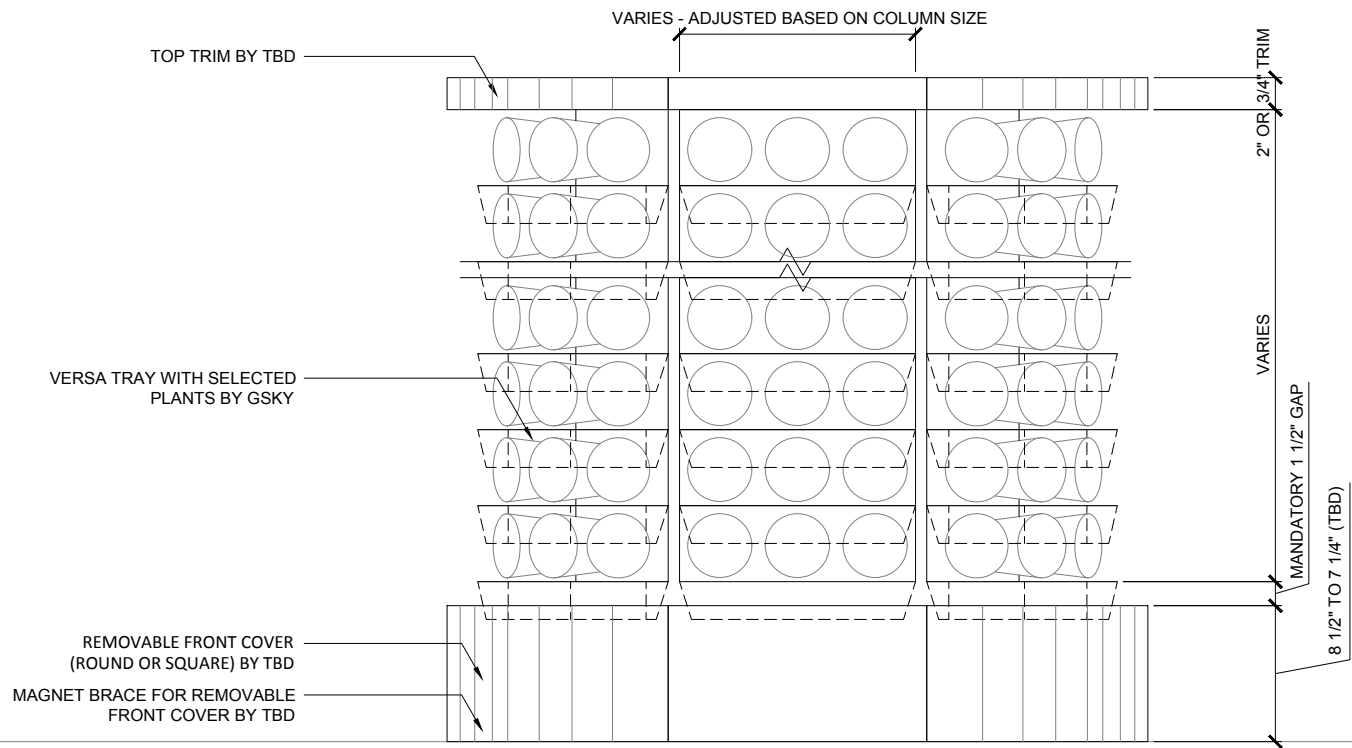

VERSAs WALL®
 DETAIL - COLUMN TYPE "A"
 VER. 1.1 11x17" (A3)

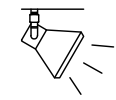

Duration
 10-12 hrs/day
 Color Temp
 4000-4500K
 Intensity
 150fc / 1500 lux
 (Even Flood)



< 8'	OK		
< 13'	OK	OK	
> 13'		OK	OK

LIGHTING
 LED or Metal Halide Lights recommended

MAINT. ACCESS
 Walls over 40' / 12m need additional considerations. See GSKy maintenance manual.

GVD6.0

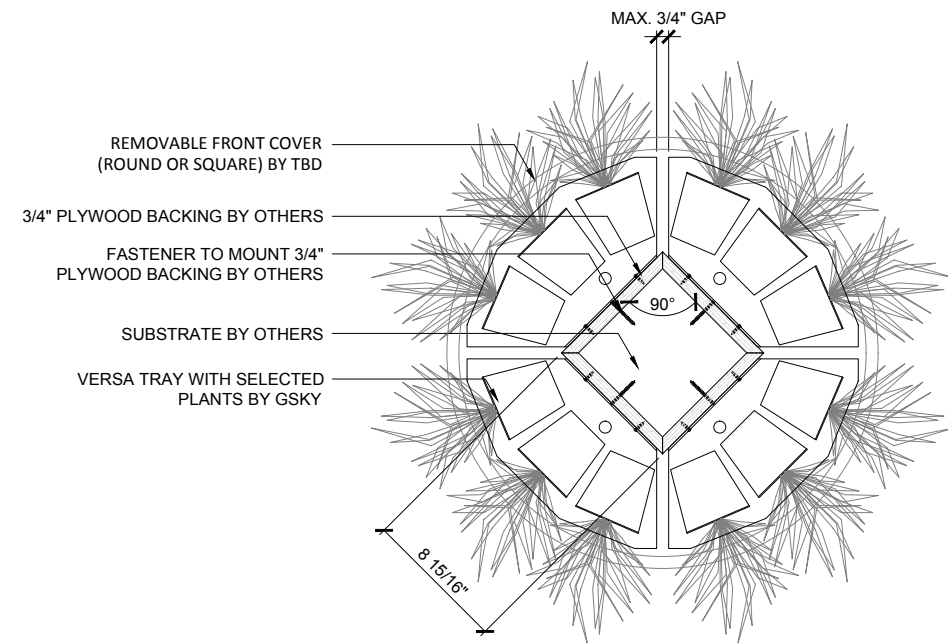
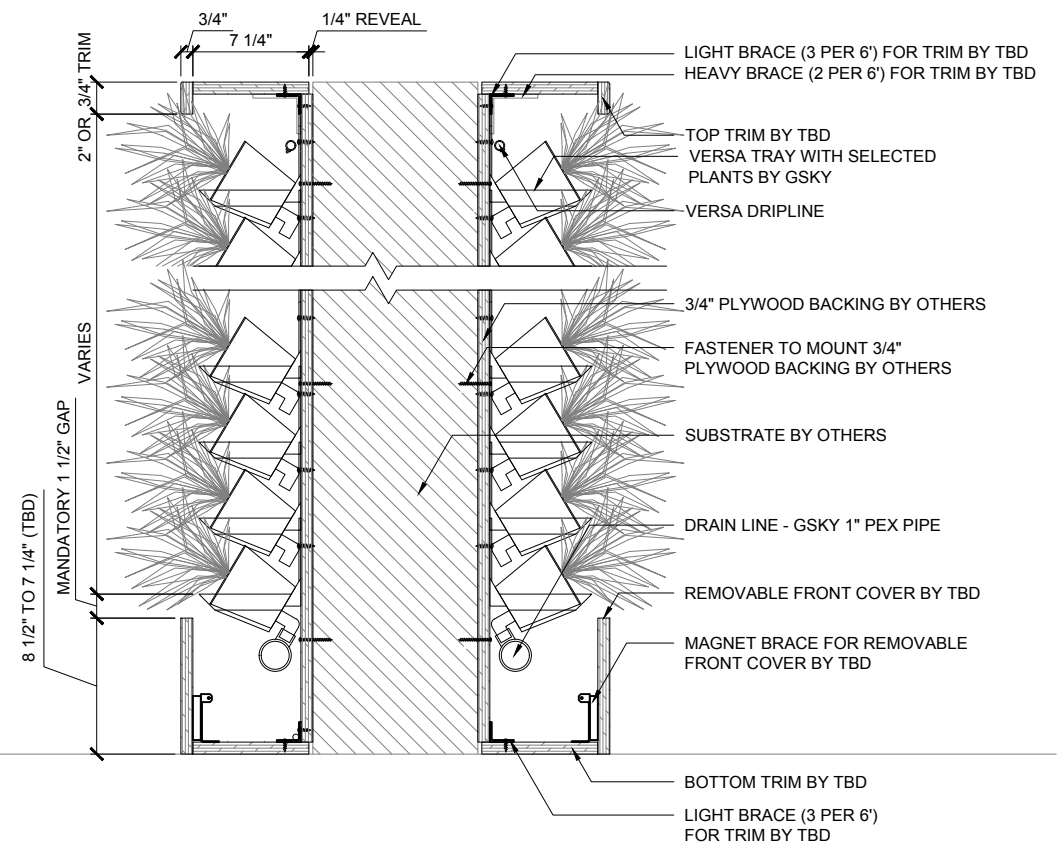
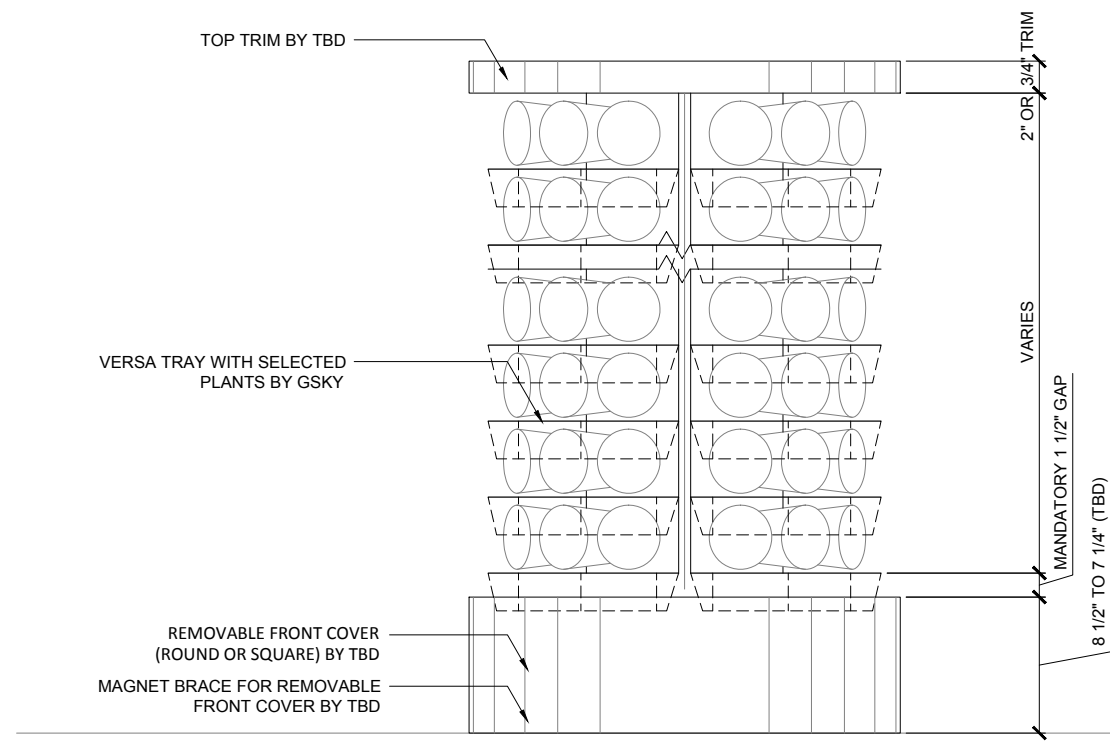

VERSA WALL®

DETAIL - COLUMN TYPE "B"

VER. 1.1

11x17" (A3)

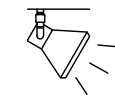

Duration
10-12 hrs/day

Color Temp
4000-4500K

Intensity
150fc / 1500 lux
(Even Flood)

LIGHTING
LED or Metal Halide Lights
recommended



< 8'	OK		
< 13'	OK	OK	
> 13'		OK	OK

MAINT. ACCESS
Walls over 40' / 12m need additional
considerations. See GSKy
maintenance manual.

GVD6.1